



- (EN) For more information see [www.nikkei.eu](http://www.nikkei.eu)
- (NL) Voor meer informatie zie [www.nikkei.eu](http://www.nikkei.eu)
- (DE) Für weitere Informationen siehe [www.nikkei.eu](http://www.nikkei.eu)
- (FR) Pour plus d'informations, veuillez consulter le site [www.nikkei.eu](http://www.nikkei.eu)
- (ES) Para más información, visite [www.nikkei.eu](http://www.nikkei.eu)
- (DK) For mere information besøg [www.nikkei.eu](http://www.nikkei.eu)
- (FI) Lisätietoja löydät osoitteesta [www.nikkei.eu](http://www.nikkei.eu)



## 1 Check the contents

Controleer de inhoud  
Kontrollieren Sie den Inhalt  
Vérifiez le contenu  
Revise el contenido  
Kontroller indholdet  
Tarkista sisältö

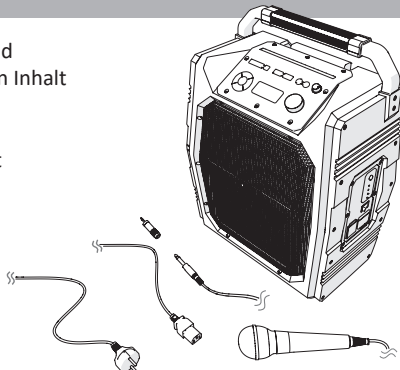

## 2 The buttons

De knoppen    Die tasten    Les boutons  
Los botones    Painikkeet    Knapperne

1	STOP
2	PREVIOUS
3	PLAY/PAUSE
4	SOURCE
5	NEXT
6	MASTER VOLUME KNOB
7	MICROPHONE VOLUME KNOB

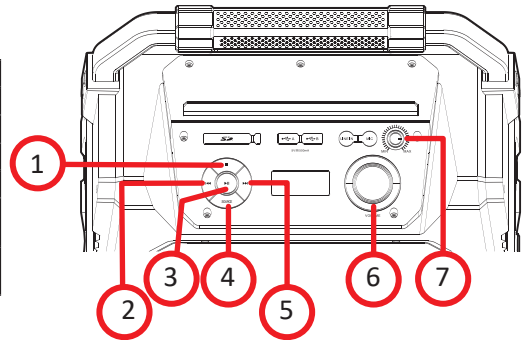

## 3 Connect to the mains and/or charge the battery

Sluit op het lichtnet aan en laad de batterij op  
Schließen Sie die Netzspannung an und laden Sie den Akku  
Raccordez au réseau électrique et charge la batterie  
Conecte a la red eléctrica, carga la batería  
Tilslut til lysnettet, oplader batteriet  
Kytke verkkovirtaan, lataa akun

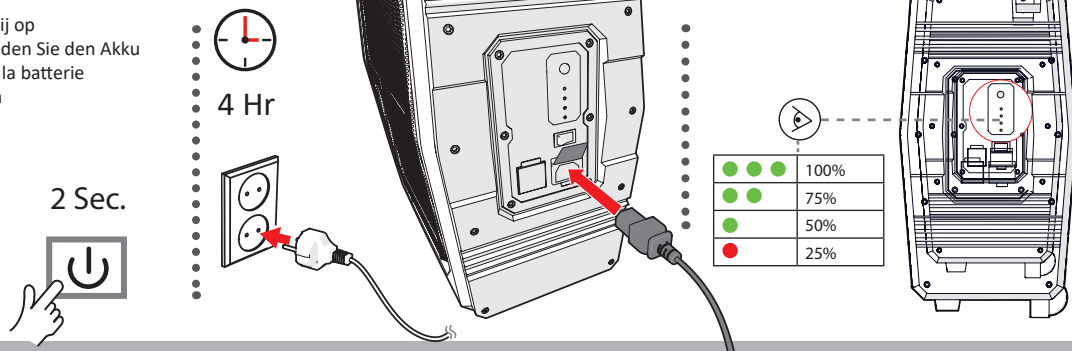

## 4 The button Source

De Source toets  
Die taste Source  
La touche Source  
La tecla Source  
Knapperne Source  
Painike Source

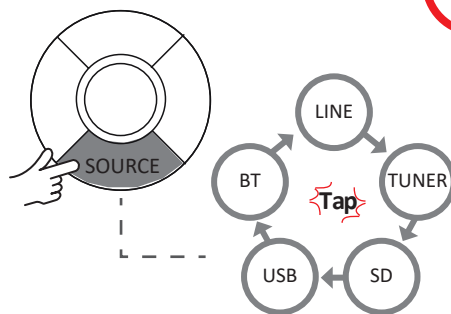

## 5 Switch to radiomode

Schakel naar de radiomodus  
Schalten Sie in den Radiomodus  
Basculez en mode radio  
Cambio a modo radio  
Skift over til radiomodus  
Siiry radiotilaan

Choose a radiostation  
Radiostation wählen  
Choisissez une station radio  
Elegir una emisora de radio  
Vælf en radiostation  
Valitse radioasema

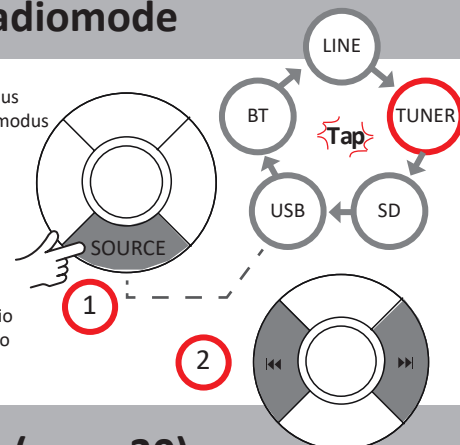

## 6 Save a radiostation automatically into the memory (max. 30)

Radiosender automatisch opslaan in het geheugen (max. 30)  
Radiosender automatisch im Speicher speichern (max. 30)  
Enregistrer la station de radio automatiquement dans la memoire (max. 30)  
Guardar una emisora de radio automático en la memoria (max. 30)  
Radiosender gemmes i hukommelsen automatisk (max. 30)  
Tallenna asema muistiin automaattisesti (max. 30)

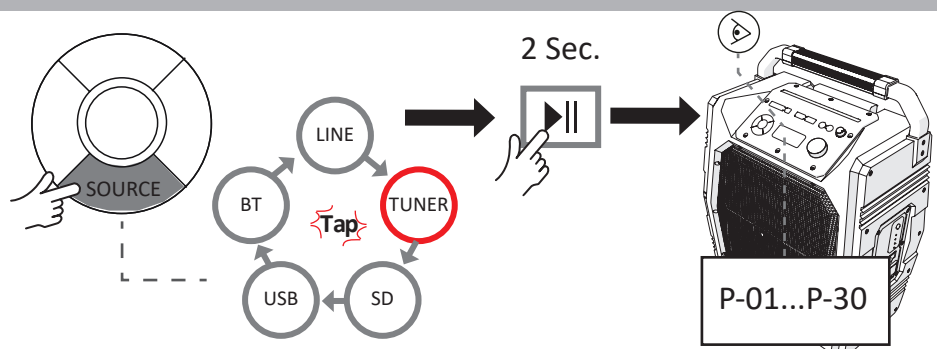

# 7

## Listen to preset radiostations

Voorkeuzezenders oproepen  
Vorzugsender aufrufen  
Appeler les émetteurs pré-chosés  
Activar estaciones favoritas  
Kald forvalgte stationer  
Suosituimplein asemien valinta

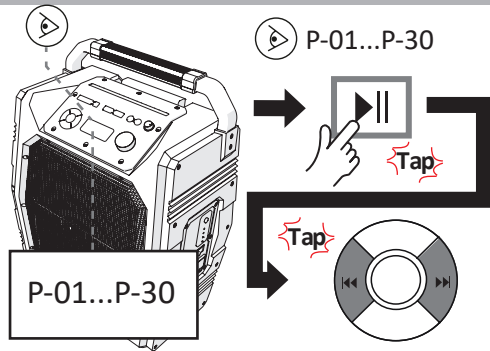
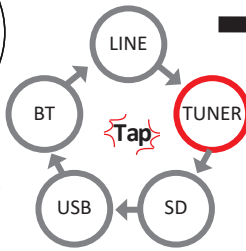
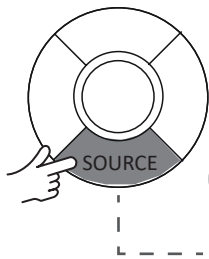

# 8

## USB and SD

USB, SD USB, SD USB, SD  
USB, SD USB, SD USB, SD

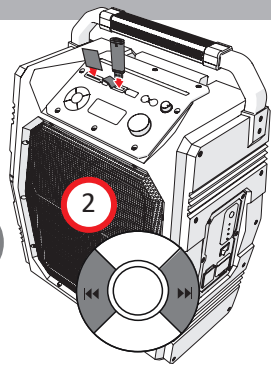
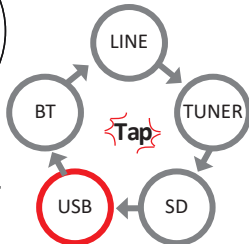
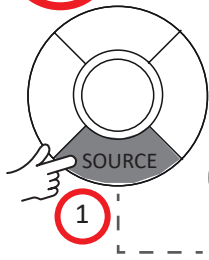

# 9

## Microphone

Microfoon Mikrofon Micro  
Micrófono Mikrofon Mikrofon

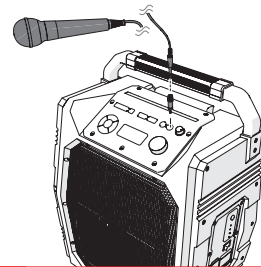
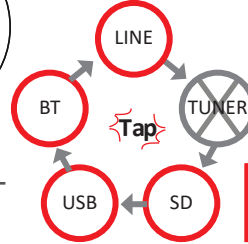
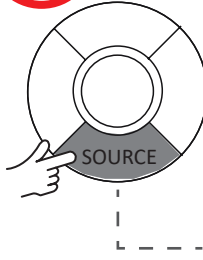

# 10

## Line in

Line in Line in Line in  
Line in Line in Line in

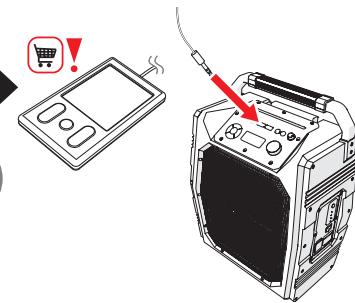
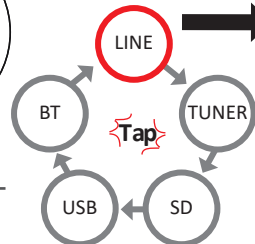
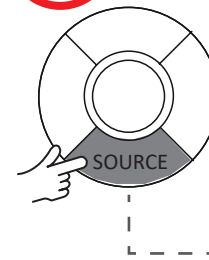

# 11

## Bass function

Bass functies  
Bass/Funktionen  
Fonctions Bass  
Funciones del Bass  
Bass/funktioner  
Bass/toiminnot

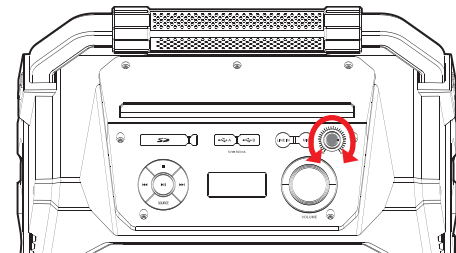

# 12

## Bluetooth connection

Bluetooth-verbinding  
Conexion- Bluetooth

Bluetooth-Verbindung  
Bluetooth tilslutning

Connexion Bluetooth  
Bluetooth-yhteys

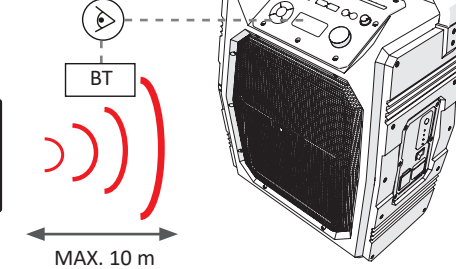
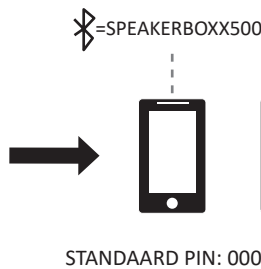
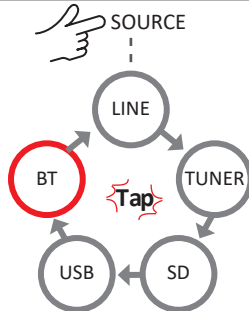
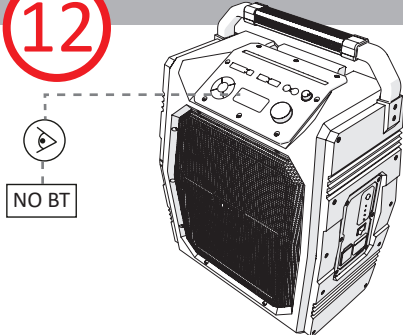

### Specifications

### Specificaties

### Technische Daten

### Spécifications

### Especificaciones

### Specifikationer

### Tekniset tiedot

Power supply:  
AC~100-240V/50/60Hz  
Power consumption: 50W

Stroomvoeding:  
AC~100-240V/50/60Hz  
Stroomverbruik: 50W

Stromzufuhr:  
AC~100-240V/50/60Hz  
Stromverbrauch: 50W

Distribution  
AC~100-240V/50/60Hz  
Consommation de  
courant: 50W  
Plage de fréquence:  
FM 87,5-108 MHz  
FM Radio

Fuente de alimentación:  
AC~100-240V/50/60Hz  
Consumo de energía: 50W  
Intervalo de frecuencia:  
FM 87,5-108 MHz  
FM Radio

Strømforsyning:  
AC~100-240V/50/60Hz  
Strømförbrug: 50W

Virtälähde:  
AC~100-240V/50/60Hz  
Virrankulutus: 50W

Frequency range:  
FM 87,5-108 MHz  
FM Radio

Frequentiebereik:  
FM 87,5-108 MHz  
FM Radio

Frequenzbereich:  
FM 87,5-108 MHz  
FM Radio

Poids: 10200 g  
Dimensions:  
413 x 544 x 245 mm  
Lead-acid batterie

Peso: 10200 g  
Dimensiones:  
413 x 544 x 245 mm  
Lead-acid batería

Vægt: 10200 g  
Dimensioner:  
413 x 544 x 245 mm  
Lead-acid bateri

Paino: 10200 g  
Mitat:  
413 x 544 x 245 mm  
Lead-acid akku

Warranty: 24 months

Garantie: 24 maanden

Garantie: 24 Monate

Garantie: 24 mois

Garantía: 24 meses

Garanti: 24 Måneder

Takuu: 24 kuukaudet