



- (EN) For more information see www.nikkei.eu
- (NL) Voor meer informatie zie www.nikkei.eu
- (DE) Für weitere Informationen siehe www.nikkei.eu
- (FR) Pour plus d'informations, veuillez consulter le site www.nikkei.eu
- (ES) Para más información, visite www.nikkei.eu
- (DK) For mere information besøg www.nikkei.eu
- (FI) Lisätietoja löydät osoitteesta www.nikkei.eu



1 Check the contents

Controleer de inhoud
Kontrollieren Sie den Inhalt
Vérifiez le contenu
Revise el contenido
Kontroller indholdet
Tarkista sisältö

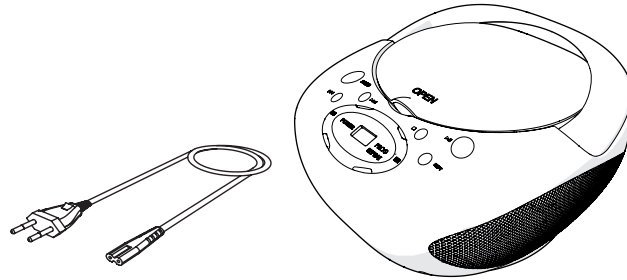

2 Connect to the mains

Sluit op het lichtnet aan
Schließen Sie die Netzspannung an
Raccordez au réseau électrique
Conecte a la red eléctrica
Tilslut til lysnettet
Kytke verkkovirtaan

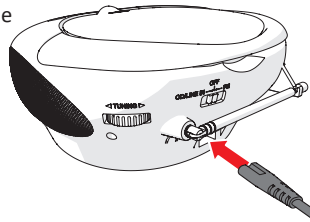

OR

Place batteries

Plaats de batterijen
Legen Sie die Batterien ein
Placez les piles
Coloque las pilas
Sæt batteriet i
Parištojen asettaminen

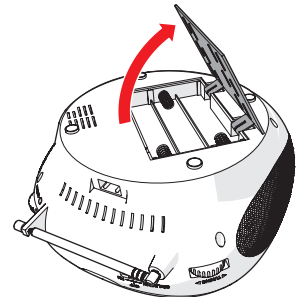

3 Function button

De functie toets
Die taste function
La touche function
La tecla function
Knapperne function
Painike function

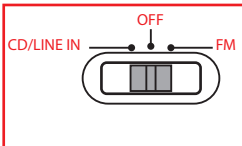
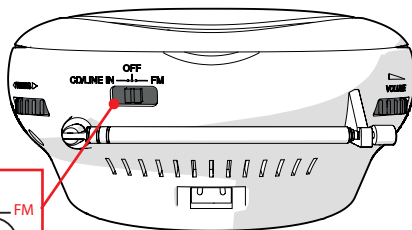

4 Switch on/off

Aan/uitzetten
Ein- oder ausschalten
Activer/Désactiver
Activación y desactivación
Tændes eller slukkes
Päälle/pois

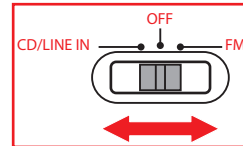
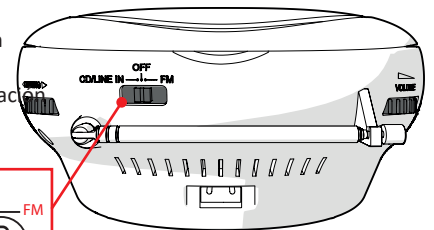

5 Slide out the antenna

Schuif de antenne uit
Antenne ausziehen
Dépliez l'antenne
Extienda la antena
Skub antennen ud
Työnnä antenni ulos

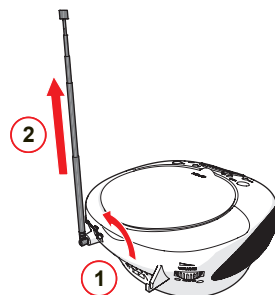

6 Select radio frequency

Kies frequentie
Wählen Sie die Frequenz
Sélectionnez la fréquence
Elija la emisora
Vælg frekvens
Valitse taajuus

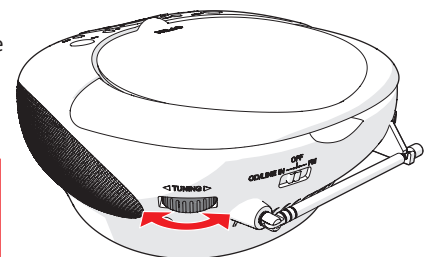
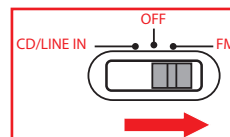

7

Adjust the volume

Pas het volume aan
 Passen Sie die Lautstärke an
 Réglez le volume
 Ajuste el volumen
 Indstil volumen
 Säädä äänenvoimakkuutta

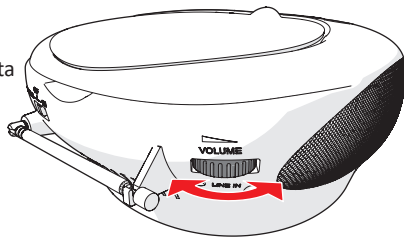

8

Insert a CD

Voer een cd in
 Legen Sie eine CD ein
 Introduisez un CD
 Insérez un CD
 Sæt en CD i
 Aseta CD

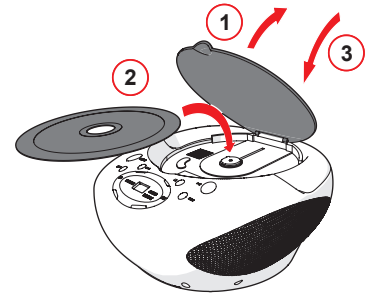
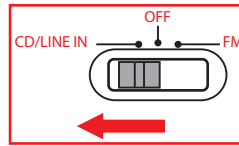

9

CD functions

CD functies
 CD-Funktionen
 Fonctions CD
 Funciones del CD
 CD-funktioner
 CD-toiminno

PROGRAM
 PREVIOUS
 NEXT

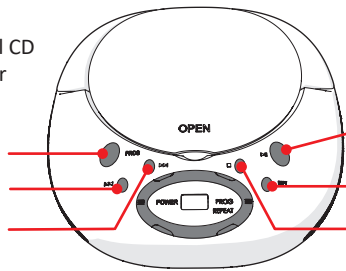

PLAY/PAUSE/
 ECO/POWER
 REPEAT
 STOP

10

Program track sequence

Programmeer track volgorde
 Programmieren Sie die
 Titelreihenfolge
 Programmer l'ordre de la piste
 Secuencia de pistas del programa
 Programmering af sporekvensen
 Ohjelmoi kappalejärjestys

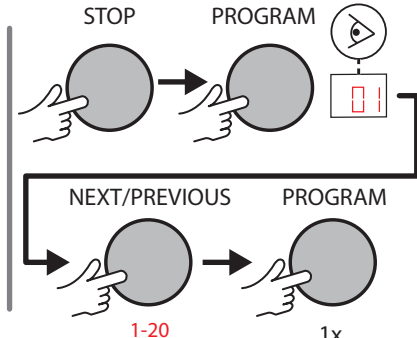
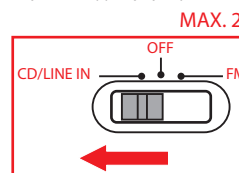

11

Connection

Aansluiting
 Buchse
 Connexion
 Conexión
 tilslutning
 iitäntä

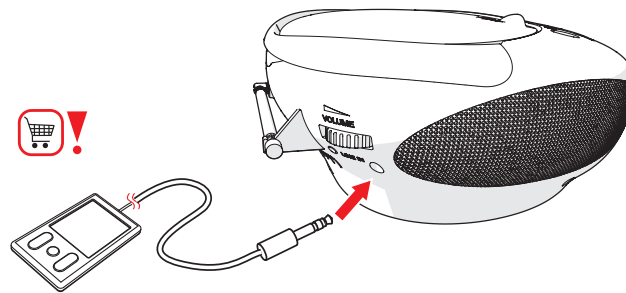
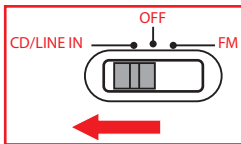

12

Switch on from standby mode

Inschakelen vanuit standby-modus
 Einschalten aus dem Standby-Modus
 Mise en marche depuis le mode veille
 Encender desde el modo standby
 Tænd fra standby-tilstand
 Kytke päälle valmiustilasta

PLAY/PAUSE/ECO/POWER

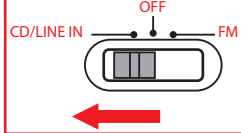
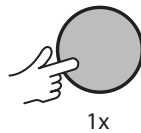

Standby Mode automatically switch off after 15 minutes

Standby-modus, automatisch uitgeschakeld na 15 minuten
 Standby-Modus, automatisches Ausschalten nach 15 Minuten
 Mode stand-by, automatiquement déactivé après 15 minutes
 Modo de espera, se desconectar automáticamente pasados 15 minutos
 Standby-tilstand, slukke automatisk efter 15 minutter
 Valmiustila, summuttaa automaattisesti 15 minuutin kuluttua



Specifications

Specificaties

Technische Daten

Spécifications

Especificaciones

Specifikationer

Tekniset tiedot

Power supply:
 AC 230V ~ 50 Hz, DC 9V
 Batteries: 6 x C (Batteries not included)
 Speaker output:
 2 x 1W RMS
 Power consumption: 12W
 FM tuner, frequency range:
 87,5 - 108 MHz
 LCD Display
 FM tuner
 Compatible with CD/ CD-R/
 CD-RW/MP3

Stroomvoeding:
 AC 230V ~ 50 Hz, DC 9V
 Batterij: 6 x C (Batterijen zijn niet bijgeleverd)
 Luidspreker output:
 2 x 1W RMS
 Energieverbruik: 12W
 FM-tuner, FM frequentie-
 bereik: 87,5 - 108 MHz
 LCD display
 FM-tuner
 Geschikt voor CD/ CD-R/
 CD-RW/MP3
 AUX aansluiting: 3.5 mm

Stromzufuhr:
 AC 230V ~ 50 Hz, DC 9V
 Batterie: 6 x C (Die Batterien sind im Lieferumfang nicht enthalten)
 Lautsprecher-Output:
 2 x 1W RMS
 Energieverbrauch: 12W
 FM-Tuner, Frequenz-bereich:
 87,5 - 108 MHz
 LCD-Display
 FM-Tuner
 Geeignet für CD/ CD-R/CD-
 RW/MP3

Alimentation électrique:
 AC 230V ~ 50 Hz, DC 9V
 Batterie: 6 x C (Les piles ne sont pas livrées)
 Sortie haut-parleur:
 2 x 1W RMS
 Consommation électrique: 12W
 FM-Tuner, Plage de fréquence:
 87,5 - 108 MHz
 Affichage LCD
 FM-Tuner
 Adapté pour CD/ CD-R/CD-
 RW/MP3

Fuente de alimentación:
 AC 230V ~ 50 Hz, DC 9V
 Batería: 6 x C (Las pilas no están incluidas)
 Salida-altavoz: 2 x 1W RMS
 Consumo de energía: 12W
 Sintonizador FM, Intervalo de frecuencia: 87,5 - 108 MHz
 Pantalla LCD
 Sintonizador FM
 Compatible con CD/ CD-R/
 CD-RW/MP3

Strømforsyning:
 AC 230V ~ 50 Hz, DC 9V
 Batteriet: 6 x C (Batterier er ikke inkluderet)
 Højttaler-output:
 2 x 1W RMS
 Energiforbrug: 12W
 FM-tuner, Frekvensområde:
 87,5 - 108 MHz
 LCD-display
 FM-tuner
 Egnert til CD/ CD-R/CD-RW/
 MP3

Syöttövirta:
 AC 230V ~ 50 Hz, DC 9V
 Paristo: 6 x C (Paristoja ei ole mukana)
 Kaiutinlähtö:
 2 x 1W RMS
 Tehonkulutus: 12W
 FM-viritin, Taajuusalue: 87,5 - 108 MHz
 Nestekidenäyttö
 FM-viritin
 Yhteensopivuus CD/ CD-R/
 CD-RW/MP3