



NPR450
Clock radio

NIKKEI

- EN For more information see www.nikkei.eu
- NL Voor meer informatie zie www.nikkei.eu
- DE Für weitere Informationen siehe www.nikkei.eu
- FR Pour plus d'informations, veuillez consulter le site www.nikkei.eu
- ES Para más información, visite www.nikkei.eu
- DA For mere information besøg www.nikkei.eu
- FI Lisätietoja löydät osoitteesta www.nikkei.eu



1 Connect to the mains

Sluit op het lichtnet aan
Schließen Sie die Netzspannung an
Raccordez au réseau électrique
Conecte a la red eléctrica
Tilslut til lysnettet
Kytke verkkovirtaan

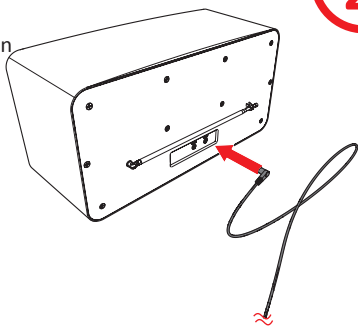
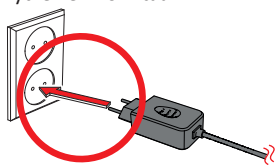

2 FUNCTION buttons

FUNCTION knoppen
FUNCTION Tasten
Boutons FUNCTION
Botones FUNCTION
FUNCTION knapperne
Painikkeet

FUNCTION

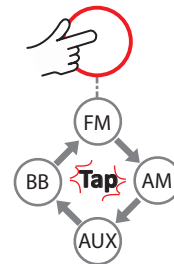

3 Buttons

Knoppen
Tasten
Boutons
Botones
knapperne
Painikkeet

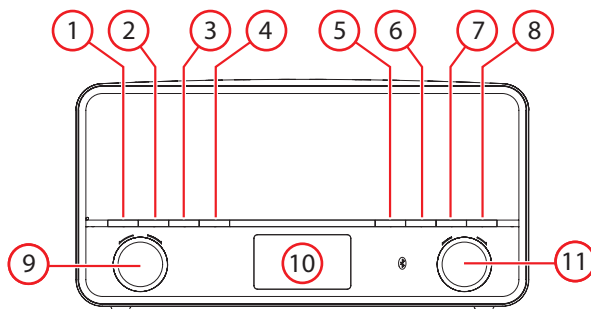

1	⏻ STANDBY	7	ALARM 1
2	FUNCTION	8	ALARM 2
3	PAIR/SCAN	9	VOLUME
4	SLEEP/ST/MO	10	DISPLAY
5	SNOOZE/DIM	11	⏪ TUNE ⏩
6	MEM/CLOCK		

4 Setting the time

Tijd instellen
Zeit einstellen
Régler l'heure
Configuración del tiempo
Indstil tid
Aseta aika

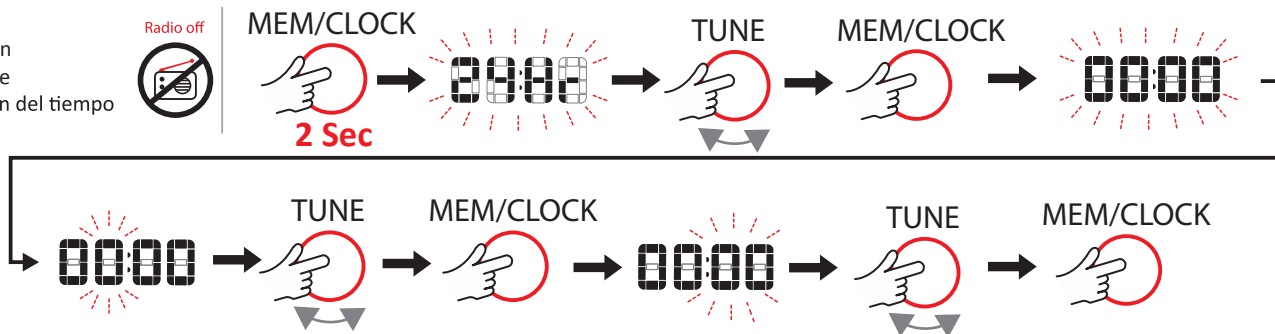

5 Setting the alarm time (1 & 2)

De alarmtijd instellen (1&2)
Einstellen der Alarmzeit (1&2)
Réglage de l'heure de l'alarme (1&2)
Ajuste de la hora de alarma (1&2)
Alarmtidspunktet indstilles (1&2)
Sääädä herätysaika (1&2)

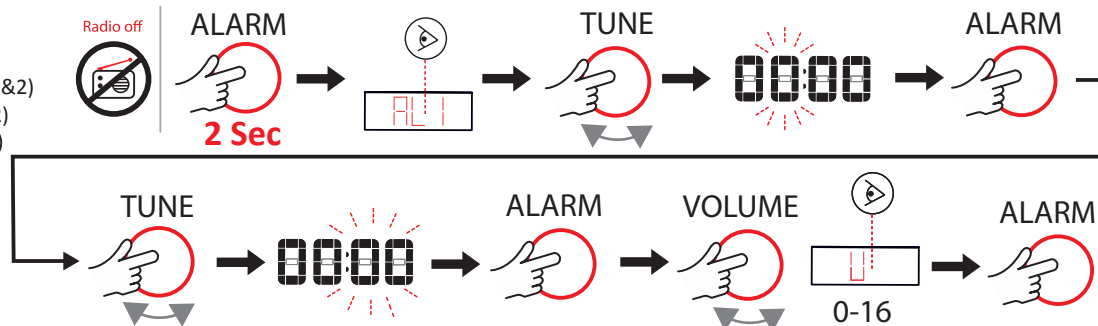

6 Setting the alarms to On or Off or Snooze

Het alarm aan- of uitzetten of uitstellen
 Wecker ein- oder ausschalten oder abstellen
 Mettre en/hors service l'alarme ou postposer l'alarme
 Activar/desactivar despertador o posponer el despertador
 Alarmen slås til eller fra til eller slås fra
 Herätyksen kytkeä päälle/pois tai torkkua

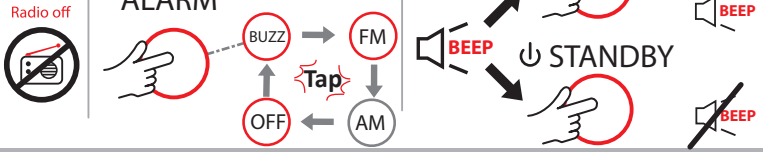

7 Switch to radiomode

Schakel naar de radiomodus
 Schalten Sie in den Radiomodus
 Basculez en mode radio
 Cambio a modo radio
 Skift over til radiomodus
 Siirry radiotilaan

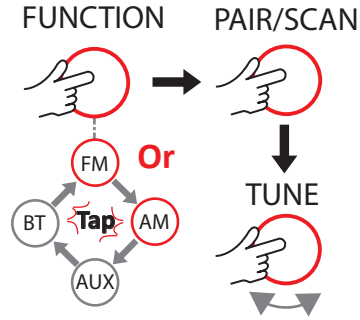
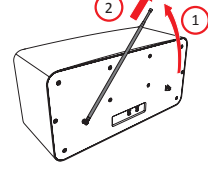

8 Save a radiostation into the memory (max. 10)

Radiozender opslaan in het geheugen (max. 10)
 Radiosender im Speicher speichern (max. 10)
 Enregistrer la station de radio dans la mémoire (max. 10)
 Guardar una emisora de radio en la memoria (max. 10)
 Radiosender gemmes i hukommelsen (max. 10)
 Tallenna asema muistiin (max. 10)

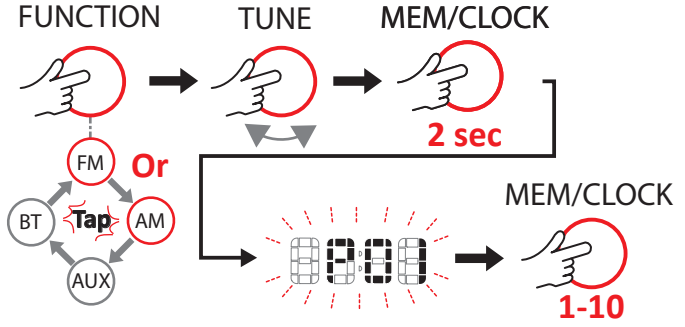

9 Recall station presets

Voorkeuzezenders oproepen
 Vorzugssender aufrufen
 Appeler les émetteurs pré-choisis
 Activar estaciones favoritas
 Kald forvalgte stationer
 Suosituimpien asemien valinta

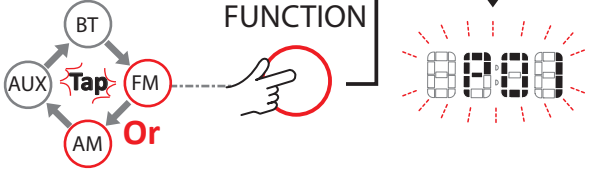

10 Sleep timer

Slaap timer
 Sleep-Timer
 Minuteur de sommeil
 Temporizador de apagado
 Dvaletimer
 Nukahtamistoiminto

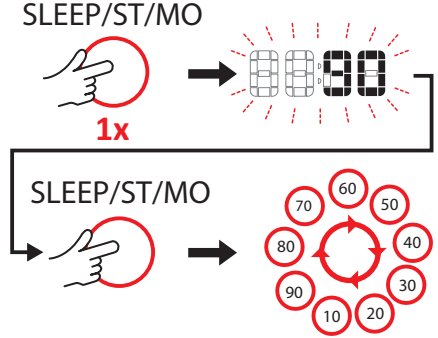

11 Bluetooth connection

Bluetooth verbinding
 Bluetooth-Verbindung
 Connexion Bluetooth
 Conexión Bluetooth
 Bluetooth tilslutning
 Bluetooth-yhteyks

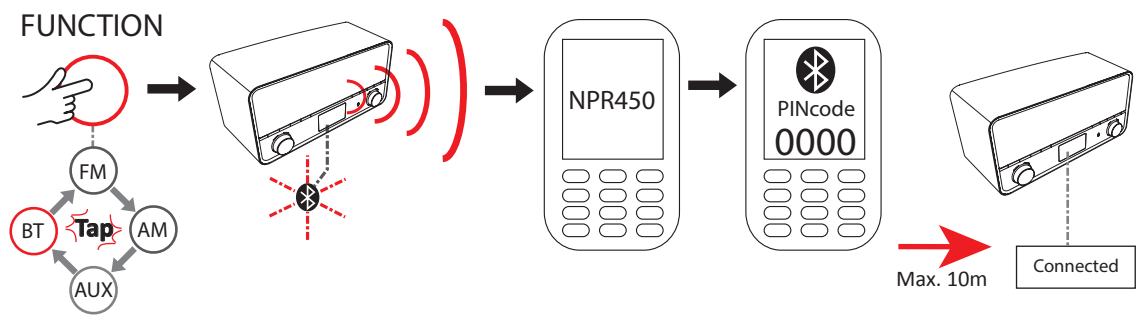

Specifications Specificaties Technische Daten Spécifications Especificaciones Specifikationer Tekniset tiedot

<p>Power supply: AC 230V ~ 50 Hz Frequency range: AM 522-1620 kHz FM 87,5-108 MHz LCD Display Sleep timer Alarm clock Digital FM Radio Weight: 1650 g Dimensions: 300x151x148 mm Warranty: 24 months</p>	<p>Stroomvoeding: AC 230V ~ 50 Hz Frequentiebereik: AM 522-1620 kHz FM 87,5-108 MHz LCD Display Slaap timer Alarmluk Digitale FM radio Gewicht: 1650 g Afmetingen: 300x151x148 mm Garantie: 24 maanden</p>	<p>Stromzufuhr: AC 230V ~ 50 Hz Frequenzbereich: AM 522-1620 kHz FM 87,5-108 MHz LCD Display Sleep-Timer Wecker Digitales FM-Radio Gewicht: 1650 g Abmessungen: 300x151x148 mm Garantie: 24 Monate</p>	<p>Alimentation électrique : AC 230V ~ 50 Hz Plage de fréquence: AM 522-1620 kHz FM 87,5-108 MHz Affichage LCD Minuteur de sommeil Horloge alarme Radio FM numérique Poids : 1650 g Dimensions : 300x151x148 mm Garantie: 24 mois</p>	<p>Fuente de alimentación: AC 230V ~ 50 Hz Intervalo de frecuencia: AM 522-1620 kHz FM 87,5-108 MHz Pantalla LCD Temporizador de apagado Reloj alarma Radio FM digital Peso: 1650 g Dimensiones: 300x151x148 mm Garantía: 24 meses</p>	<p>Strømforsyning: AC 230V ~ 50 Hz Frekvensområde: AM 522-1620 kHz FM 87,5-108 MHz LCD-display Dvaletimer Alarmur Digital FM-radio Vægt: 1650 g Dimensioner: 300x151x148 mm Garanti: 24 måned</p>	<p>Syöttövirta: AC 230V ~ 50 Hz Taajuusalue: AM 522-1620 kHz FM 87,5-108 MHz Lcdnäyttö Nukahtamistoiminto Herätyskello Digitaalinen FM-radio Paino: 1650 g Mitat: 300x151x148 mm Takuu: 24 kuukautta</p>
--	--	--	---	--	---	--