



- (EN) For the complete manual see www.nikkei.eu
- (NL) Voor de complete handleiding zie www.nikkei.eu
- (DE) Das vollständige Benutzerhandbuch finden Sie auf www.nikkei.eu
- (FR) Pour le manuel complet, voir www.nikkei.eu
- (ES) Para tener acceso a todo el manual, visite www.nikkei.eu
- (DK) Se hele vejledningen på www.nikkei.eu
- (FI) Täydellinen käyttöopas on osoitteessa www.nikkei.eu



1 Check the content

Controleer de inhoud
Kontrollieren Sie den Inhalt
Vérifiez le contenu
Revise el contenido
Kontroller indholdet
Tarkista sisältö

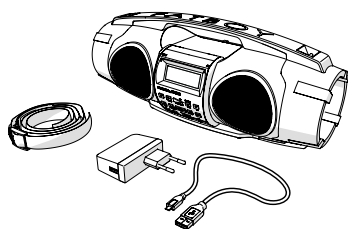

2 Connect to the mains

Sluit op het lichtnet aan
Schließen Sie die Netzspannung an
Raccordez au réseau électrique
Conecte a la red eléctrica
Tilslut til lysnettet
Kytke verkkovirtaan

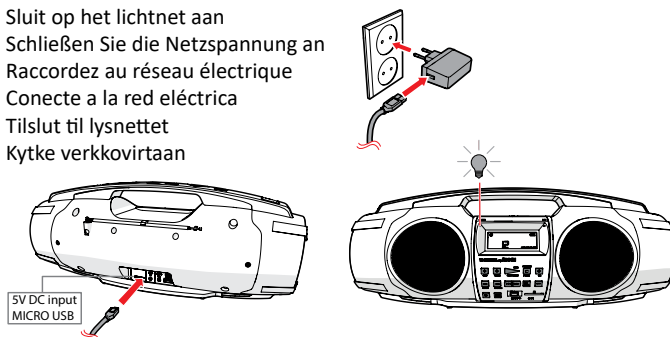

3 Main parts & buttons

Hoofonderdelen en knoppen
Partes principales y botones

Hauptteile und -tasten
Hoveddele og knapper

Principaux éléments et boutons
Tärkeimmät osat ja painikkeet

1	Passive Subwoofer (left)	22	Station/previous
2	LCD display	23	Antenna
3	LED charge indicator	24	Power 5V Micro USB slot
4	Handle	25	Headphone jack
5	LED indicator (Bluetooth)	26	AUX input
6	Speaker	27	USB output charger
7	Passive Subwoofer (right)	A	Bluetooth icon
8	On/off button	B	Play mode:
9	Function button	↻	Repeat current track
10	Bass control -	📁	Repeat current folder
11	Treble -	📁	Repeat all tracks in all folders
12	Bass control +	🔀	Shuffle
13	Treble +	C	Status accu
14	Play/pause/connect	D	Bass/Treble overview
15	Prog/mem	E	FM: shows frequency
16	Volume up		USB: shows quantity of tracks
17	Memory+/folder+		CARD: shows quantity of tracks
18	Volume down		AUX: shows quantity of tracks
19	Station/next		BT: shows volume
20	SD slot	F	The current function or mode
21	USB slot		

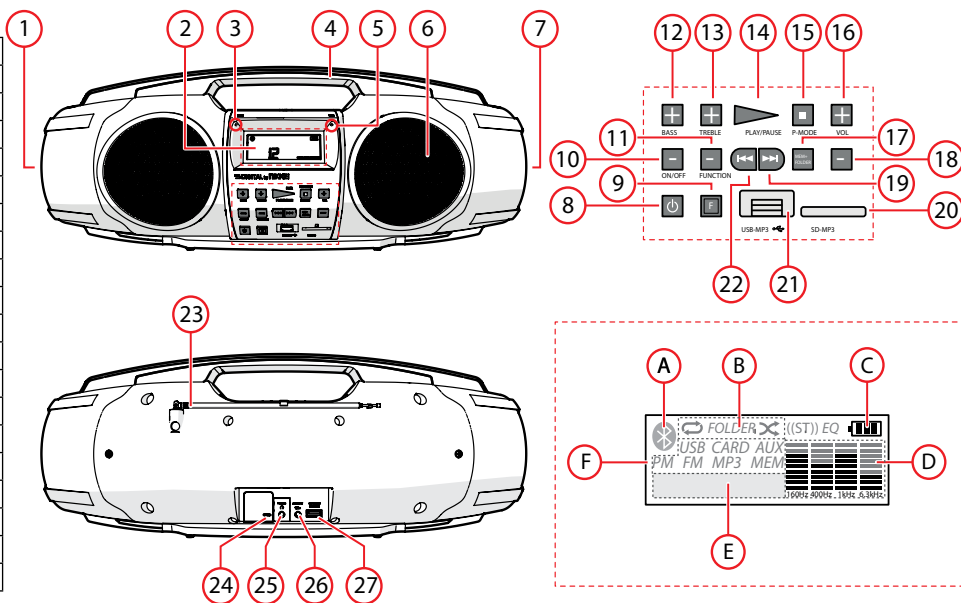

4 Function button

De functie toets
Die taste function
La touche function
La tecla function
Knapperne function
Toimintopainike

FUNCTION (9)

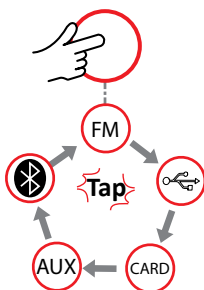

5 Set the radio frequency

Stel de radiofrequentie in
Einstellen der Radiofrequenz
Réglez la fréquence radio
Ajuste automático de frecuencia
Indstil radiofrekvensen
Aseta radiotaajuus

FUNCTION (9)

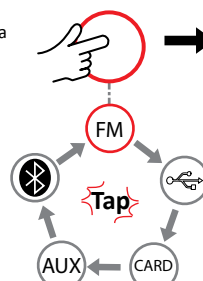

NEXT (19)
/PREV (22)

2 Sec.

6

Set station presets (Max. 20)

Stel voorkeuzezenders in (Max. 20)
 Vorzugssender einstellen (Max. 20)
 Préprogrammez les stations de radio (Max. 20)
 Ajuste de las emisoras presintonizadas (Max. 20)
 Indstil forvalgte stationer (Max. 20)
 Määritä asemien pikavalinnat (Max. 20)

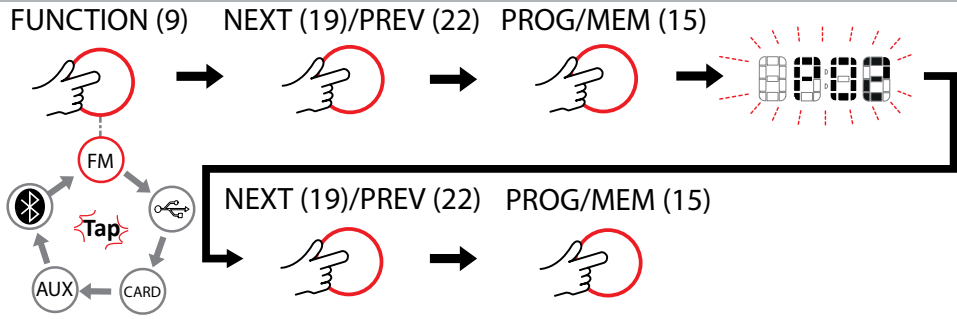

7

Recall station presets

Vorkeuzezenders oproepen
 Gespeicherten Sender abrufen
 Rappelez les stations préprogrammées
 Recuperación de las emisoras presintonizadas
 Hent forvalgte stationer
 Käytä aseman pikavalintaa

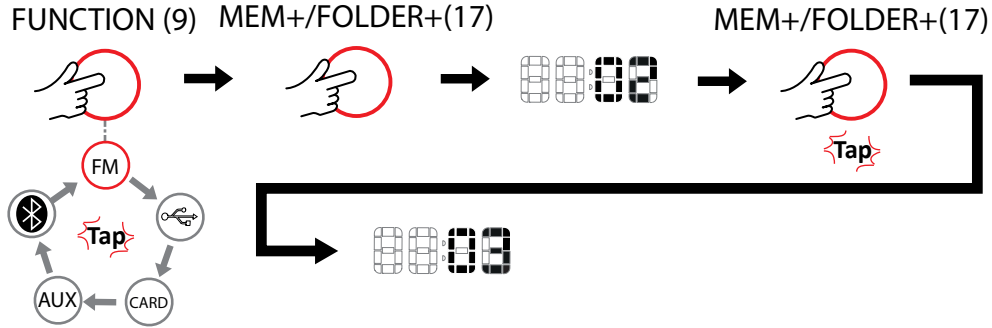

8

Program track sequence (Max. 20)

Programmeer track volgorde (Max. 20)
 Programmieren Sie die Titelreihenfolge (Max. 20)
 Programmez l'ordre des pistes (Max. 20)
 Programación de la secuencia de pistas (Max. 20)
 Programmering af sporsekvensen (Max. 20)
 Ohjelmoi kappalejärjestys (Max. 20)

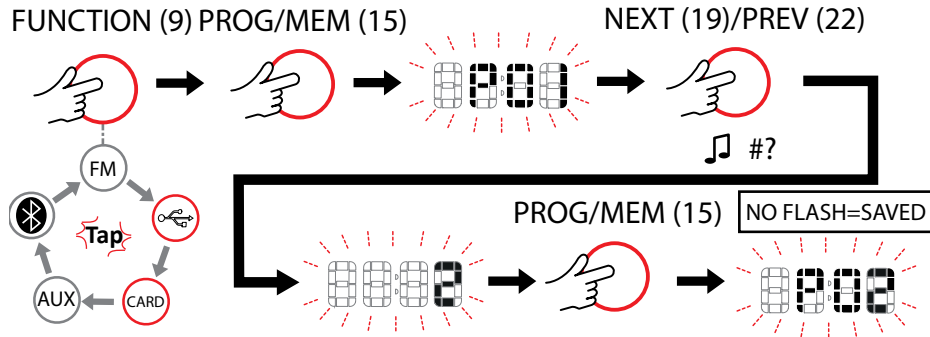

9

Making a Bluetooth connection

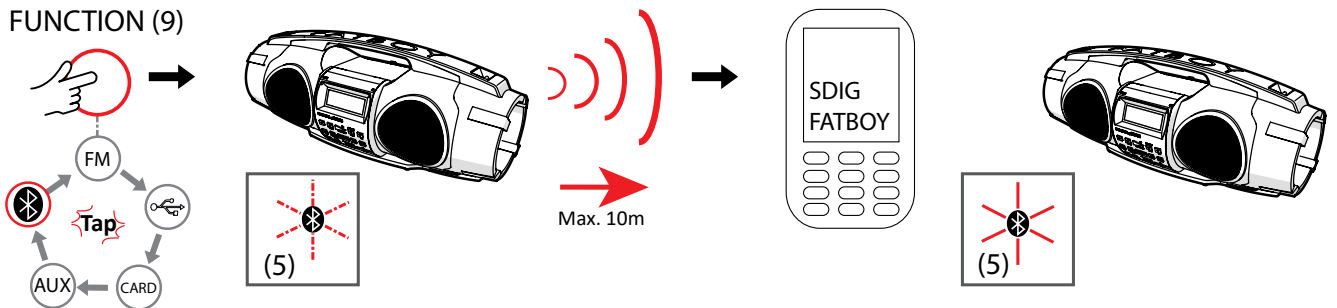

Specifications

Specificaties

Technische Daten

Spécifications

Especificaciones

Specifikationer

Tekniset tiedot

Power supply: AC 100-240V, 50-60 Hz,	Stroomvoeding: AC 100-240V, 50-60 Hz	Stromversorgung: AC 100-240 V, 50-60 Hz	Alimentation électrique: AC 100-240V, 50-60 Hz	Fuente de alimentación: AC 100-240V, 50-60 Hz	Strømforsyning: AC 100-240V, 50-60 Hz	Syöttövirta: AC 100-240V, 50-60 Hz
Battery capacity: 2100 mAh	Capaciteit battery: 2100 mAh	Akkukapasitität: 2100 mAh	Capacité de la batterie : 2100 mAh	Capacidad de la batería: 2100 mAh	Batterikapacitet: 2100 mAh	Akun kapasiteetti: 2100 mAh
USB output: 5V-1A	USB output: 5V-1A	USB-Ausgang: 5 V-1 A	Sortie USB : 5V-1A	Salida USB: 5V-1A	USB-output: 5V-1A	USB-lähtö: 5 V, 1 A
Battery type: Lithium-ion	Batterij type: Lithium ion	Akkutyp: Lithium-ionen-Akku	Type de batterie : Lithium-ion	Tipo de batería: ión-litio	Batteritype: Lithium-ion	Akun tyyppi: litium-ion
FM tuner, frequency range: 87,5 - 108 MHz LCD Display FM tuner AUX-IN	FM-tuner, FM frequentie- bereik: 87,5 - 108 MHz LCD display FM-tuner AUX-IN	FM-Tuner, Frequenzbereich: 87,5 - 108 MHz LCD-Display FM-Tuner AUX-IN	Tuner FM, plage de fréquence : 87,5 - 108 MHz Affichage LCD Tuner FM AUX-IN	Sintonizador FM, Intervalo de frecuencia: 87,5 - 108 MHz Pantalla LCD Sintonizador FM AUX-IN	FM-tuner, frekvensområde: 87,5 - 108 MHz LCD-display FM-tuner AUX-IN	FM-viritin, taajuusalue: 87,5 - 108 MHz Nestekidenäyttö FM-viritin AUX-IN