

# NIKKEI

# GIMBAL 3X MOTORIZED STABILIZER

## INSTRUCTION MANUAL - ENGLISH

### 1. Product Overview

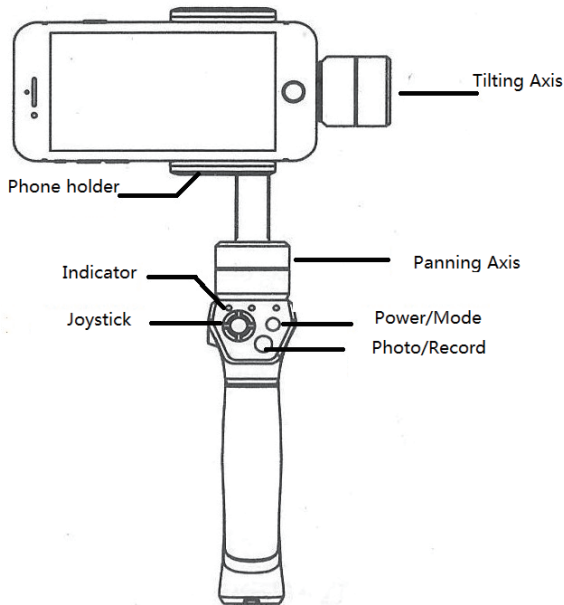

### 2. Accessories

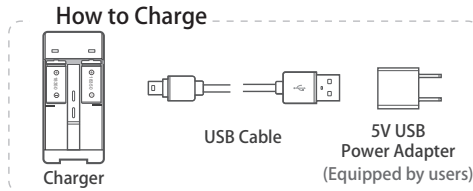
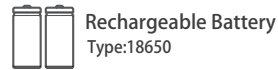

▶ Connect the Mini-USB port of the USB cable with the charger, and the USB port with 5V USB power adapter.

### 3. User Guide

- ⚠ (1) Please install the iPhone before powering on the gimbal.
- (2) Please turn off the power when not in use.

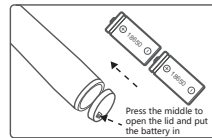

**1** Install the batteries  
Remove the power switch cap, and insert two 18650 batteries into the handle.

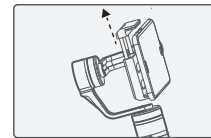

**2** Install the phone  
Attach the iPhone by the quick-release adapter, and ensure it is secure.

#### 3 Adjust the phone position and install the counter-weight

- ⚠ (1) iPhone 6(s) Plus and over 5-inch smartphones need use counter-weight.
- (2) less than 4.5-inch smartphones do not need to use counter-weight.

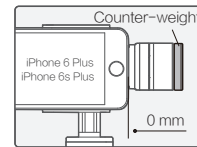

How to install iPhone 6s Plus / 6 Plus

Use the counter-weight, attach the bottom of the phone to the motor of tilting axis, as shown in the picture.

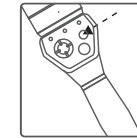

#### 4 Power on / off

**Power On:** Press the Function Button for one second to turn on the gimbal.  
**Power Off:** Press the Function Button for one second to turn off the gimbal.  
**Attention:** Turn the gimbal on after ensuring the phone is secure.

### 4. Operating

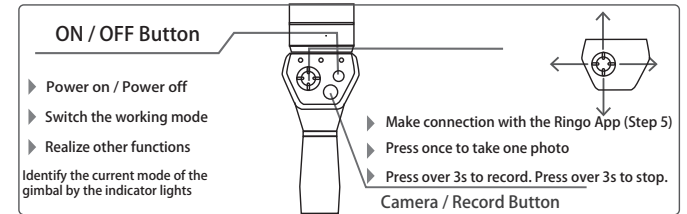

#### Explanation of LED indicator status

LED status	Mode / Status
Single flash	Panning mode
Double flashes	Panning and Tilting mode
Three flashes	Standby
Always on	Lock mode / Initialize the gimbal

#### Explanation of joystick control

Mode	Controllable angle of joystick	Movement of joystick
Panning mode	Tilting angle	Up, Down
Panning and Tilting mode	Uncontrollable	Uncontrollable
Lock mode	Tilting and panning angle	Up, Down, Left, Right

#### Operating Instructions of Function Button

Operation	Function	Explanation
Single tap	Panning Mode / Lock Mode	Single tap to switch between panning mode and lock mode
Double tap	Panning and Tilting Mode	Under panning and tilting mode, single tap to switch to lock mode
Triple tap	Inversion Mode	It is possible to switch to other modes under inversion mode, triple tap again to exit inversion mode and reset
Quadruple tap	Reset	Reset the tilting axis of the gimbal to initial orientation and initial mode.
Long press for 1 second	Standby	Single tap again to awake the gimbal, or triple tap to initialize the gimbal
Long press for 3 seconds	Power off	

#### Working Modes

##### Panning Mode

The phone is allowed to pan left or right. Vertical tilts or rolls are restricted.

##### Panning and Tilting Mode

The phone is allowed to pan left or right and tilt up and down. Rolls are restricted.

##### Lock Mode

The phone stays in its current orientation. All panning, tilting and rolls are restricted.

#### Other Functions

##### Inversion Mode

Three working modes can be switched under inversion mode. After entering into the inversion mode, the gimbal automatically switches to the panning mode. Invert the gimbal, put the camera face down to capture the wonderful moments. The gimbal can restore to the boot-up state by consecutively pressing the function button for three times under inversion mode.

## Manual Pulling Locking

After the gimbal being powered on for eight seconds, pull the tilting axis to the desired angle under non panning and tilting mode and wait for 0.5 second until the gimbal registers the new angle.

## Reset

Reset the tilting axis of the gimbal to initial orientation and initial mode.

## Standby

In standby model, keep the gimbal in power-up state, the motor stops working, the indicator light flashes for three times, and single tap again to wake the gimbal.

## 5. Ringo App

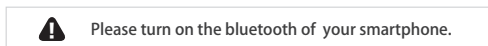

### Connect to Gimbal

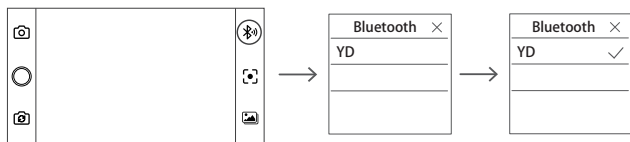

Click "Connect to Gimbal" icon. Choose "YD" option in the pop-up window.

### State Tracking

Click "State Tracking" icon to activate. When this icon turns green, State Tracking mode is on. Choose the tracking object and a green rectangle will show. The gimbal will auto follow the target inside the green rectangle.

## 6. Gimbal Horizontal Angle Adjustment

The horizontal angle needs to be adjusted whenever the following situations happen to the gimbal, user can adjust the horizontal angle by gimbal initialization and joystick.

- (1) The tilt angle is not leveled with the horizontal surface.
- (2) The roll angle is not parallel to the horizontal surface.
- (3) Under lock mode, the panning angle drifts.

### Adjusting steps:

- (1) After powering the gimbal on, hold down the function button for one second to enter standby mode, and the LED indicator shall flash for three times;
- (2) Consecutively tap the function button for three times, LED indicator shall be always on, place the gimbal on a flat surface and keep it stationary;
- (3) When the initialization is completed, the LED indicator will flash for three times.

## 7. Parameters

Vertical Tiltting Angle	320°
Rolls Angle	100°
Horizontal Panning Angle	360°
Titling Increments	2° /s ~ 75° /s
Panning Increments	3° /s ~ 150° /s
Usage time	9 Hours
Adaption	Support 3.5~6.1 Inch Smartphone
Weight	386g (not including batteries, phone, or counter-weight) Counter-weight 52g

## Notes

- Please correctly assemble the gimbal in accordance with the diagram.
- Please install the camera before powering on the gimbal.
- Please charge the battery with the standard charger.
- When the gimbal is not in use or placed on the table, please ensure it is powered off.
- Please correctly mount the battery with right direction.
- Please do not disassemble the gimbal apart.
- Please install the smartphone before powering on the gimbal.

## ⚠️ DISCLAIMER

3-Axial handheld gimbal for iPhone is an excellent camera stabilizer, lightweight and portable. Prohibit any user for any illegal purpose. Users will be responsible for all behaviors of purchase and use products.

The Company assumes no liability for any risks related to or resulting from the debug and use of this product (including the direct, indirect or third-party losses).

For any unknown sources of using, we will not be at any services.

BrosFuture reserves the right to amend this manual and the terms and conditions of use the gimbal at any time.

## Quick Scan to download Ringo APP

Download the app for Android:



Download the app for Apple:

