



- EN For more information see [www.nikkei.eu](http://www.nikkei.eu)
- NL Voor meer informatie zie [www.nikkei.eu](http://www.nikkei.eu)
- D Für weitere Informationen siehe [www.nikkei.eu](http://www.nikkei.eu)
- F Pour plus d'informations, veuillez consulter le site [www.nikkei.eu](http://www.nikkei.eu)
- E Para más información, visite [www.nikkei.eu](http://www.nikkei.eu)
- DK For mere information besøg [www.nikkei.eu](http://www.nikkei.eu)
- FI Lisätietoja löydät osoitteesta [www.nikkei.eu](http://www.nikkei.eu)



## 1 Connect to the mains

Sluit op het lichtnet aan  
Schließen Sie die Netzspannung an  
Raccordez au réseau électrique  
Conecte a la red eléctrica  
Tilslut til lysnettet  
Kytke verkkovirtaan

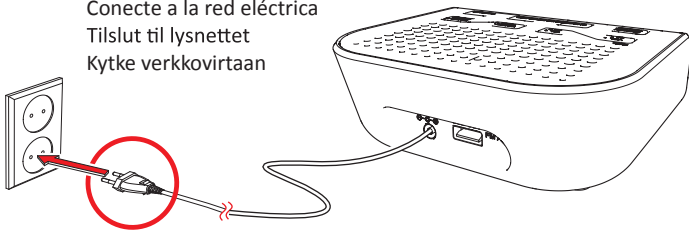

## 2 Place batteries

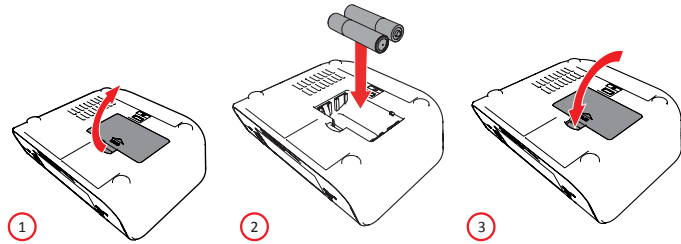

## 3 Setting the time

Tijd instellen  
Zeit einstellen  
Régler l'heure  
Configuración del tiempo  
Indstil tid  
Aseta aika

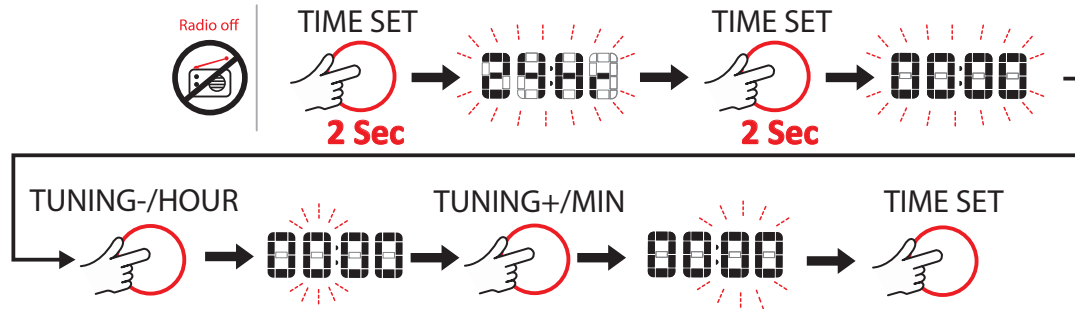

## 4 Setting the alarm time

De alarmtijd instellen  
Einstellen der Alarmzeit  
Réglage de l'heure de l'alarme  
Ajuste de la hora de alarma  
Alarmtidspunktet indstilles  
Säädä herätysaika

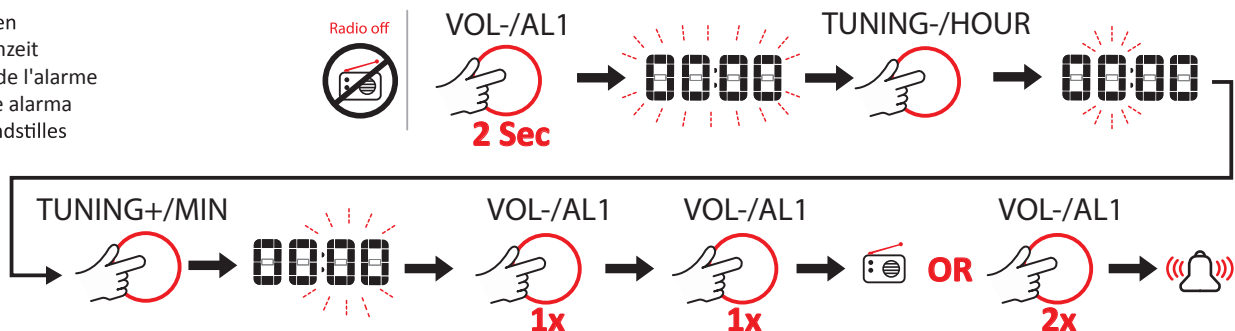

## 5 Activating the alarm

Alarm activeren  
Alarm aktivieren  
Activer l'alarme  
Activación de la alarma  
Alarm aktiveres  
Herätysten aktivointi

Radio off

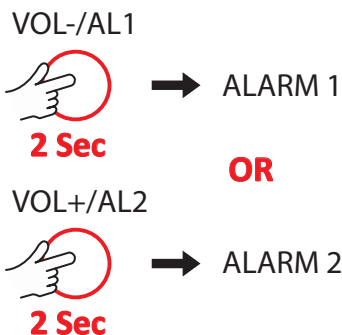

## 6 Show alarm

Alarm weergeven  
Den Alarm wiedergeben  
Afficher l'alarme  
Reproducción de la alarma  
Gengiv alarm  
Näytä herätys

Radio off

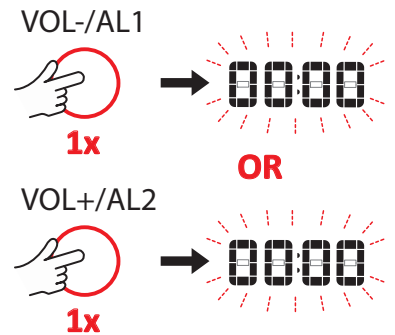

## 7 Snooze function

Sluimeralarm  
Schlummerfunktion  
Rappel d'alarme  
Alarma de repetición  
Slumrealarm  
Torkkuherätys

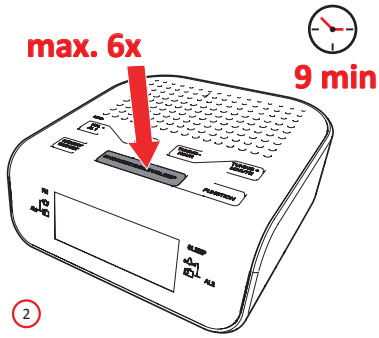

1

2

## 8 Setting the brightness lower

De lichtintensiteit lager instellen  
Lichtintensität geringer einstellen  
Diminuer l'intensité de la lumière  
Disminuir el brillo  
Indstil lysintensiteten lavere  
Himmennä valaistus

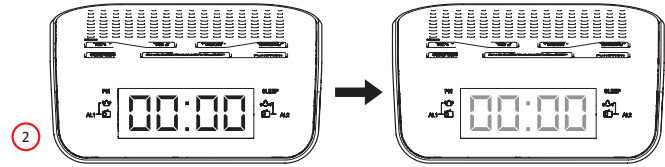
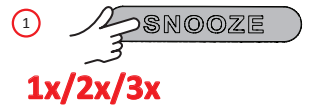

2

## 9 Adjust the volume

Pas het volume aan  
Passen Sie die Lautstärke an  
Réglez le volume  
Ajuste el volumen  
Indstil volumen  
Sääd äänenvoimakkuutta

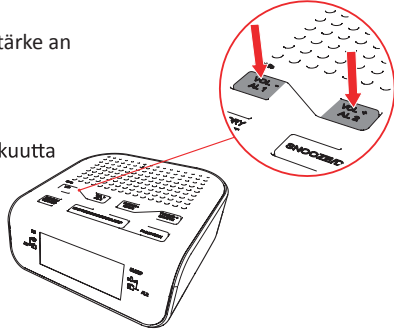

## 10 Switch to radiomode

Schakel naar de radiomodus  
Schalten Sie in den Radiomodus  
Basculez en mode radio  
Cambio a modo radio  
Skift over til radiomodus  
Siirry radiotilaan

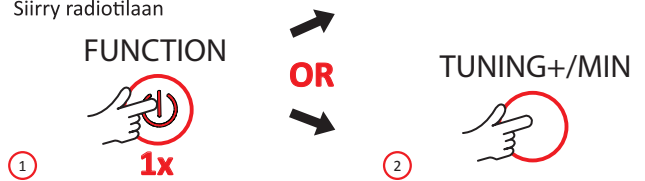

## 11 Save a radiostation into the memory (max. 20)

Radiozender opslaan in het geheugen (max. 20)  
Radiosender im Speicher speichern (max. 20)  
Enregistrer la station de radio dans la mémoire (max. 20)  
Guardar una emisora de radio en la memoria (max. 20)  
Radiosender gemmes i hukommelsen (max. 20)  
Tallenna asema muistiin (max. 20)

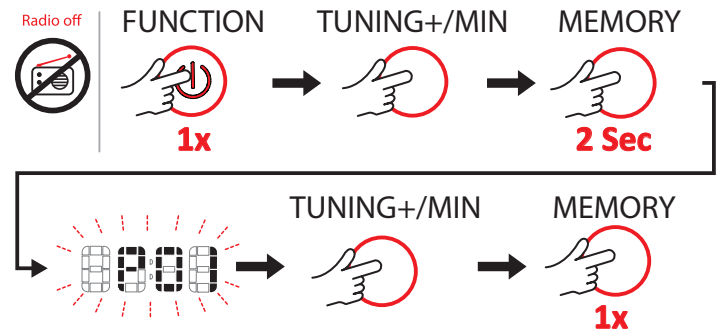

## 12 Sleep timer

Slaap timer  
Sleep-Timer  
Minuteur de sommeil  
Temporizador de apagado  
Dvaletimer  
Nukahtamistoiminto

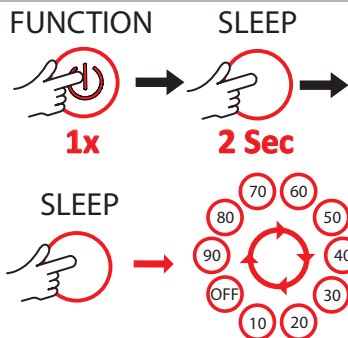

Radio off

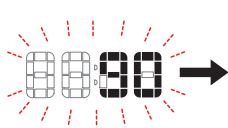

## 13 USB connection to charge device

USB aansluiting om apparaat te laden  
USB-Anschluss, um Gerät zu laden  
Connexion USB pour charger un appareil  
Conexión USB para cargar el aparato  
USB til at lade apparatet op  
USB-liitäntä laitteen lataamista varten

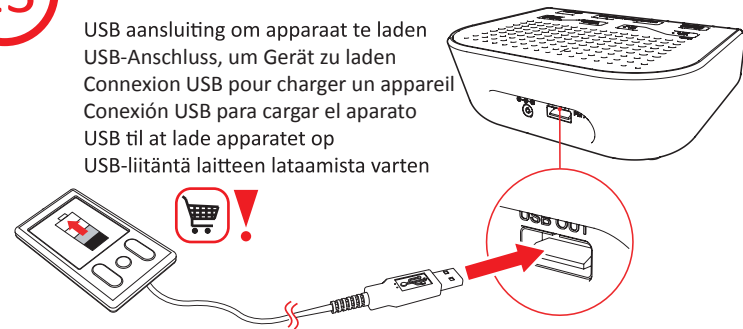

### Specifications

Power supply:  
AC 100-240V ~ 50/60 Hz  
Power consumption: 3,5W  
USB DC output: 5V 1A  
Batteries: 2 x AA  
Frequency range:  
FM 87,5-108 MHz  
LCD Display  
Sleep timer  
Alarm clock  
Weight: 360 g  
Dimensions:  
140x120x60 mm  
Warranty: 24 months

### Specificaties

Stroomvoeding:  
AC 100-240V ~ 50/60 Hz  
Energieverbruik: 3,5W  
USB DC uitgang: 5V 1A  
Batterijen: 2 x AA  
Frequentiebereik:  
FM 87,5-108 MHz  
LCD Display  
Slaap timer  
Alarmluk  
Gewicht: 360 g  
Afmetingen:  
140x120x60 mm  
Garantie: 24 maanden

### Technische Daten

Stromzufuhr:  
AC 100-240V ~ 50/60 Hz  
Energieverbrauch: 3,5W  
USB DC-Ausgang: 5V 1A  
Batterien: 2 x AA  
Frequenzbereich:  
FM 87,5-108 MHz  
LCD-Display  
Sleep-Timer  
Wecker  
Gewicht: 360 g  
Abmessungen:  
140x120x60 mm  
Garantie: 24 Monate

### Spécifications

Alimentation électrique :  
AC 100-240V ~ 50/60 Hz  
Consommation électrique:  
3,5W  
Sortie USB DC: 5V 1A  
Piles: 2 x AA  
Plage de fréquence:  
FM 87,5-108 MHz  
Affichage LCD  
Minuteur de sommeil  
Horloge alarme  
Poids : 360 g  
Dimensions :  
140x120x60 mm  
Garantie: 24 mois

### Especificaciones

Fuente de alimentación:  
AC 100-240V ~ 50/60 Hz  
Consumo de energía: 3,5W  
Salida de CC USB: 5V 1A  
Pilas: 2 x AA  
Intervalo de frecuencia:  
FM 87,5-108 MHz  
Pantalla LCD  
Temporizador de apagado  
Reloj alarma  
Peso: 360 g  
Dimensiones:  
140x120x60 mm  
Garantía: 24 meses

### Specifikationer

Strömforsyning:  
AC 100-240V ~ 50/60 Hz  
Energiförbruk: 3,5W  
USB DC utgång: 5V 1A  
Batterier: 2 x AA  
Frekvensområde:  
FM 87,5-108 MHz  
LCD-display  
Dvaletimer  
Alarmlur  
Vægt: 360 g  
Dimensioner:  
140x120x60 mm  
Garanti: 24 måned

### Tekniset tiedot

Syöttövirta:  
AC 100-240V ~ 50/60 Hz  
Tehonkulutus: 3,5W  
Usb tasasähkölähtö: 5V 1A  
Paristo: 2 x AA  
Taajuusalue:  
FM 87,5-108 MHz  
Nestekidenäyttö  
Nukahtamistoiminto  
Herätyskello  
Paino: 360 g  
Mitat:  
140x120x60 mm  
Takuu: 24 kuukautta