

**DECODED**

*- Designed to distinguish -*

# Leather keyboard case for Ipad Air 2

USER MANUAL

EN



# Table of contents

<b>1</b>	<b>Intended use</b>	<b>3</b>
<b>2</b>	<b>Safety</b>	<b>4</b>
2.1	Labels in this manual	4
2.2	General safety instructions	4
<b>3</b>	<b>Preparations for use</b>	<b>5</b>
3.1	Unpacking	5
3.2	Package contents	5
<b>4</b>	<b>Before use</b>	<b>6</b>
4.1	Charging	6
4.2	LED Indication	6
<b>5</b>	<b>Overview of the buttons</b>	<b>7</b>
<b>6</b>	<b>Use</b>	<b>9</b>
6.1	Placing the IPAD	9
6.2	Establishing a bluetooth connection	9
<b>7</b>	<b>Technical data</b>	<b>12</b>
<b>8</b>	<b>Cleaning and maintenance</b>	<b>13</b>
<b>9</b>	<b>Disposal of used electric and electronic equipment</b>	<b>14</b>

# 1 Intended use

---

The leather keyboard case is a keyboard. By means of a bluetooth connection, one can type on an Ipad Air 2 via the keyboard.

## 2 Safety

---

### 2.1 Labels in this manual

**⚠ WARNING** A warning means that injury or death is possible if the instructions are not obeyed.

**⚠ CAUTION** A caution means that damage to the equipment is possible.

**i** A note gives additional information, e.g. for a procedure.

### 2.2 General safety instructions

**⚠ WARNING** Do not use the tablet while driving a vehicle or while walking.

**⚠ CAUTION** Do not suddenly disconnect the tablet during formatting or uploading and downloading. This can result in program errors and a non-functional product.

**⚠ CAUTION** Do not try to disassemble this device and do not use alcohol, thinners or petrol to clean the surface of the device.

**⚠ CAUTION** Do not drop the product or hit it against a hard surface, as this may damage it.

**⚠ CAUTION** Do not spill any liquid on the appliance.

**⚠ Caution!** The new battery performs best after it has been fully charged and discharged 2-3 times.

**i** This appliance is double insulated; therefore no earth wire is required. Always check that the mains voltage corresponds to the voltage on the rating plate.

## 3 Preparations for use

---

### 3.1 Unpacking

- Unpack the appliance carefully.
- Check the package contents as described below. If any item is missing, please contact your reseller.
- Remove the labels from the front panel carefully if present.

**i** We recommend that you retain the original carton and packing materials in case it ever becomes necessary to return your product for service. This is the only way to safely protect the product against damage in transit. If you do dispose of the carton and the packing materials, please remember to recycle with due care to the environment.

### 3.2 Package contents

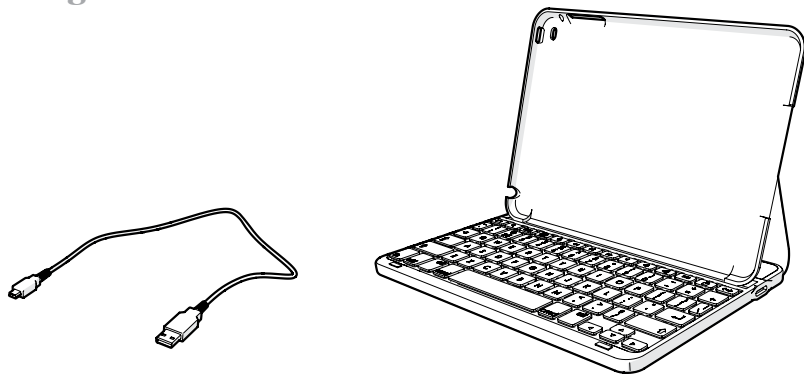

The following items are included in the received package:

- 1 x leather keyboard case
- 1 x Micro USB cable
- 1 x Quick start guide

**i** If any item is missing, please contact your reseller.

## 4 Before use

---

### 4.1 Charging

To charge the battery, connect the adapter to the DC power connector of the device and to the power supply. Charge the battery at least 4 hours before first usage.

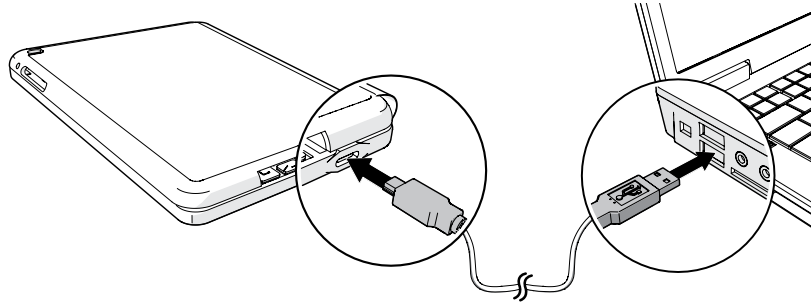

### 4.2 LED Indication

Blue LED:

- Bluetooth mode is now activated.

Red LED:

- The red LED may flash when the leather keyboard case is switched on and is not connected to a power source. This indicates the battery needs to be recharged.

Green LED remains lit:

- Battery fully charged.

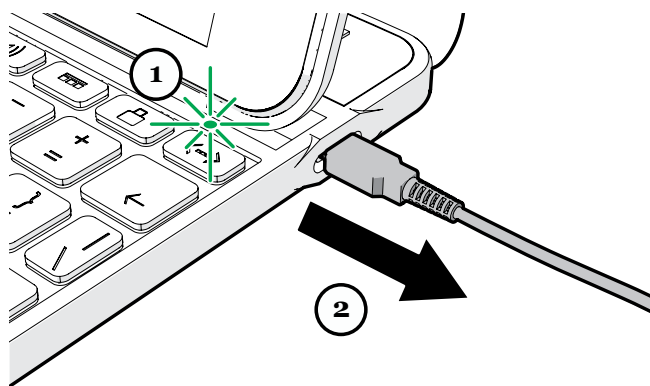

Orange LED:

- CAPS LOCK is switched on

## 5 Overview of the buttons

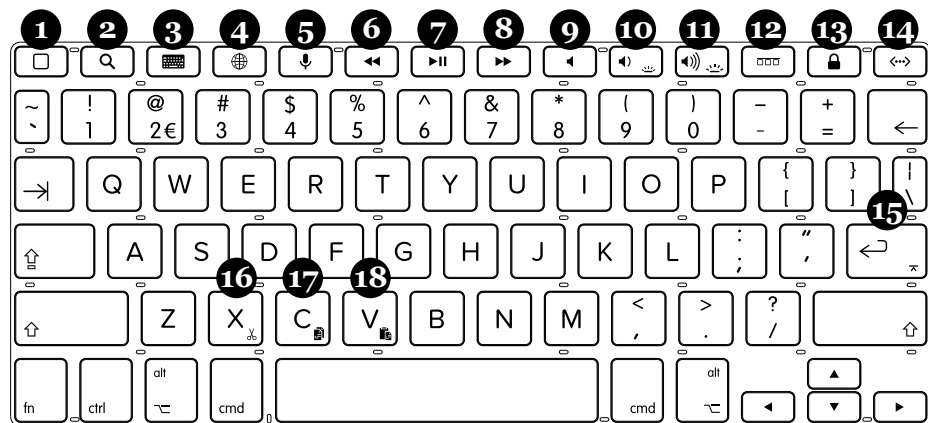

1. HOME PAGE button
  - Push this button to return to the home screen.
2. SEARCH button
  - Push this button to open the search page.
3. KEYBOARD button
  - Push this button to switch the keyboard on the IPAD on or off.
4. LANGUAGE button
  - Push this button to set the language.
5. MICROPHONE button
  - Push this button to switch the microphone on or off.
6. FAST REWIND button
  - Push this button to rewind music.
7. PLAY/PAUSE button
  - Push this button to play or pause music.
8. FAST FORWARD button
  - Push this button to fast forward music.
9. MUTE button
  - To mute or restore sound, press the MUTE button .
10. VOLUME-/LIGHT- button
  - Push this button to decrease the volume.
  - Hold the FN button on the keyboard and press this button to decrease the brightness of the IPAD screen.
11. VOLUME+/LIGHT+ button
  - Push this button to increase the volume.
  - Hold the FN button on the keyboard and press this button to increase the brightness of the IPAD screen.
12. SYSTEM button

13. LOCK button

- Push this button to lock/unlock the keyboard.

14. CONNECT button

15. ENTER

16. CUT button

- Hold the FN button on the keyboard and press this button to cut text.

17. COPY button

- Hold the FN button on the keyboard and press this button to copy text.

18. PASTE button

- Hold the FN button on the keyboard and press this button to paste text.



## 6 Use

### 6.1 Placing the IPAD

Place the iPad in the docking station

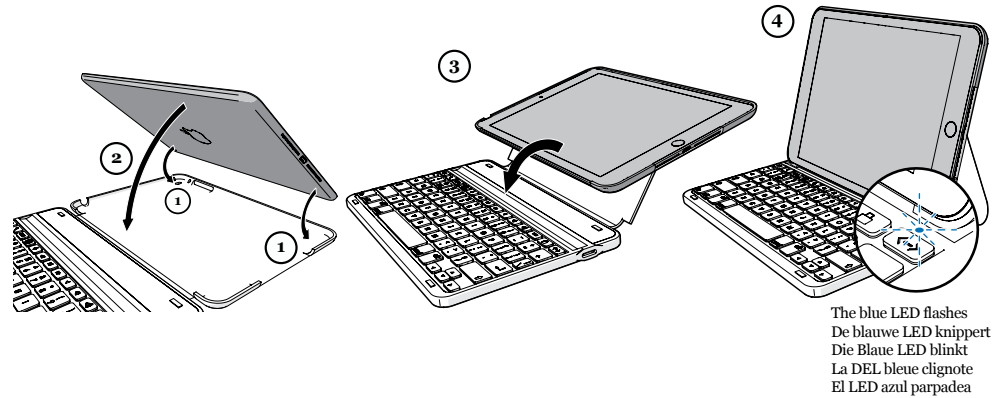

### 6.2 Establishing a bluetooth connection

- Keep key CONNECT pressed for 2 seconds

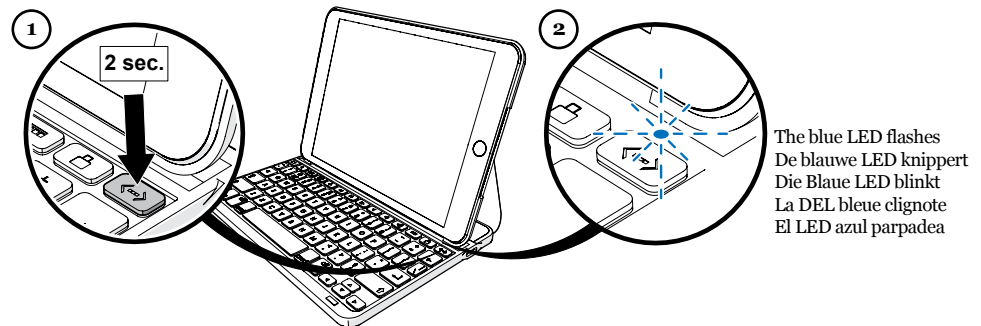

You will see the blue LED flashing .

- Press 'Settings'.

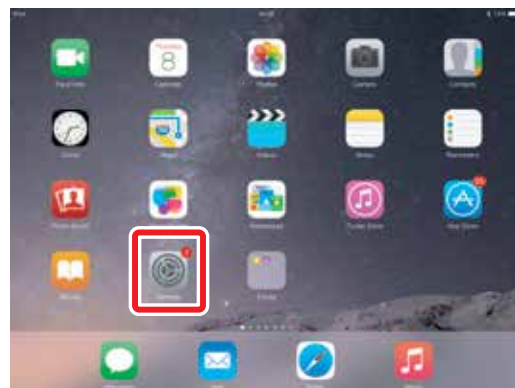

- Press 'Bluetooth'.

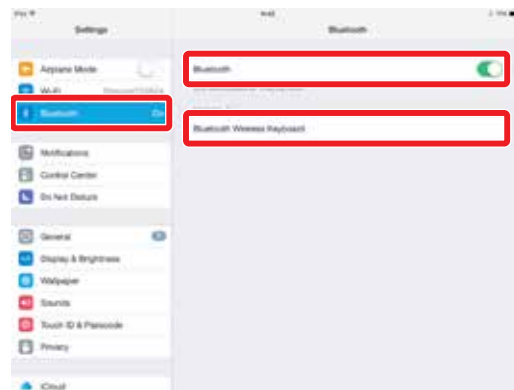

- Switch on bluetooth.
- Press 'Bluetooth Wireless Keyboard'.

A notification with a password appears on the IPAD.

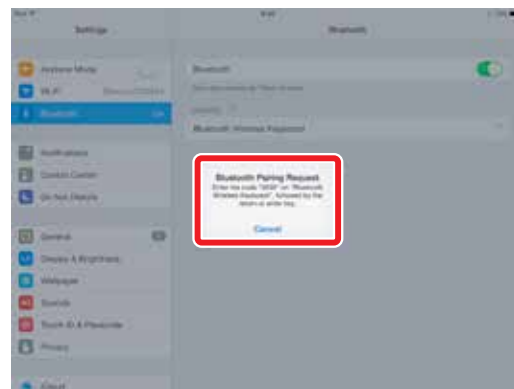

- Type the password on the keyboard and press ENTER.



The Bluetooth device is connected

### Reconnect via Bluetooth

- Place the iPad in the docking station

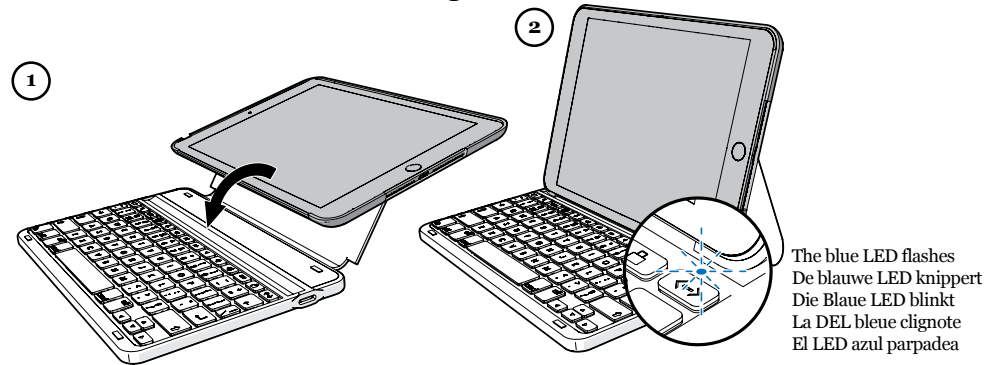

- Switch on bluetooth.

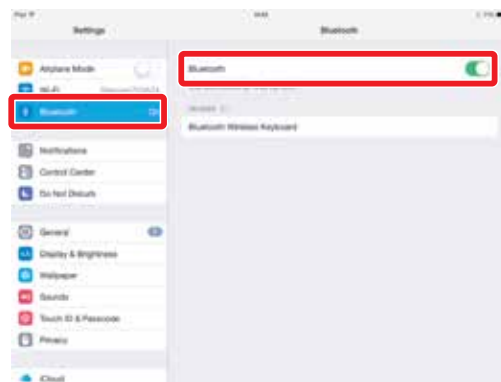

## 7 Technical data

---

- Voltage: DC 3,7 V
- Power consumption during charging: 300 mA
- Standby power consumption: 0,5 mA
- Standby time: max. 260 days
- Operating temperature: 0~55 °C
- Battery: Lithium 402675
- Battery capacity: 700 mAh
- Frequency: 2.4 GHz
- Micro USB connection
- Bluetooth3.0 connection

## 8 Cleaning and maintenance

---

**⚠ WARNING** Before performing any cleaning or maintenance, switch off and unplug the appliance.

- Clean the outside of the appliance with a soft cloth. When the appliance is very dirty, dampen the cloth slightly with water and a neutral solution.

## 9 Disposal of used electric and electronic equipment

---



The meaning of the symbol on the material, its accessory or packaging indicates that this product shall not be treated as household waste. Please, dispose of this equipment at your applicable collection point for the recycling of electrical and electronic equipments waste. In the European Union and Other European countries which there are separate collection systems for used electrical and electronic product. By ensuring the correct disposal of this product, you will help prevent potentially hazardous to the environment and to human health, which could otherwise be caused by unsuitable waste handling of this product. The recycling of materials will help conserve natural resources. Please do not therefore dispose of your old electrical and electronic equipment with your household waste.

- For more detailed information about recycling of this product, please contact your local city office, your household waste disposal service or the shop where you purchased the product.
- For more information and warranty conditions, please visit: [www.decodedbags.com](http://www.decodedbags.com)
- Do not dispose of batteries as household waste but take them to a battery recycling facility.