

AWS10 Manual



Index

- 1. Intended use
- 2. Safety
 - 2.1. Labels in this manual
 - 2.2. General safety instructions
- 3. Preparations for use
 - 3.1. Unpacking
 - 3.2. Package contents
- 4. Installation
 - 4.1. Connections
 - 4.2. Charge the battery
- 5. Functions
 - 5.1. ASW10BK Bluetooth speaker
- 6. Operation
 - 6.1. Turning the device on and off.
 - 6.2. Operation with BLUETOOTH
 - 6.3. AUX IN
 - 6.4. USB connection to charge device
- 7. Cleaning and maintenance
- 8. Technical data
- 9. Disposal of used electrical and electronic equipment

1.Intended use

The appliance works as a speaker/ amplifier. Via the bluetooth connection music can be played wirelessly. It is also possible to play music using the AUX connection. The appliance contains a built-in rechargeable battery and can charge external devices using the USB connection.

Read the manual carefully before the first use.

2.Safety

2.1. Labels in this manual



WARNING A warning means that injury or death is possible if the instructions are not obeyed.



CAUTION A caution means that damage to the equipment is possible.



A note gives additional information, e.g. for a procedure.

2.2. General safety instructions



WARNING

The AWS10 can play music in an environmental temperature that does not exceed 50°C (122°F). When the environmental temperature exceeds 50°C (122°F), the product could be damaged, catch fire or explode.



CAUTION Do not spill any liquid on the appliance.



CAUTION Do not block the ventilation holes.



CAUTION Do not put the appliance near a heat source.

3.Preparations for use

3.1. Unpacking

- Unpack the appliance carefully.
- Check the package contents as described below. If any item is missing, please contact your reseller.



We recommend that you retain the original carton and packing materials in case it ever becomes necessary to return your product for service. This is the only way to safely protect the product against damage in transit. If you do dispose of the carton and the packing materials, please remember to recycle with due care to the environment.

3.2. Package contents

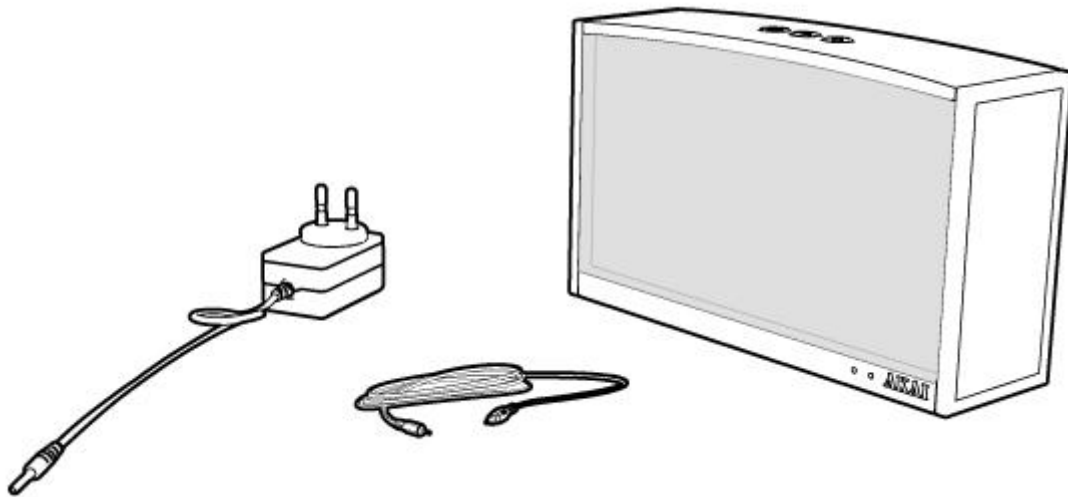

The following items are included in the received package:

- 1 x ASW10BK
- 1 x AUX cable (3.5 mm)
- 1 x AC adapter
- 1 x Quick start guide



If any item is missing, please contact your reseller.

4.Installation

- Put the appliance on a horizontal flat surface.
- Connect the random equipment to the appliance. Read the paragraph "Connecting external devices".
- Charge the rechargeable build in battery.

See for instructions section 4.1



CAUTION

- Do not put the appliance near a heat source.
- Do not expose the appliance to direct sunlight.

4.1. Connections

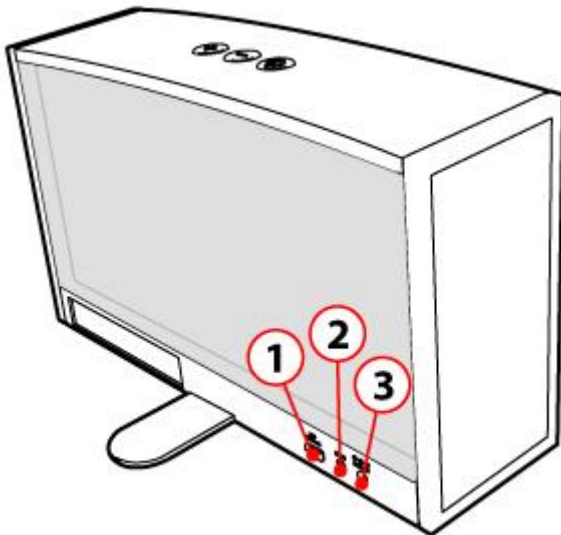

1. USB input
2. AUX input
3. DC IN input

For extended instructions, read the paragraph "Operation" further on in this manual.

4.2. Charge the battery

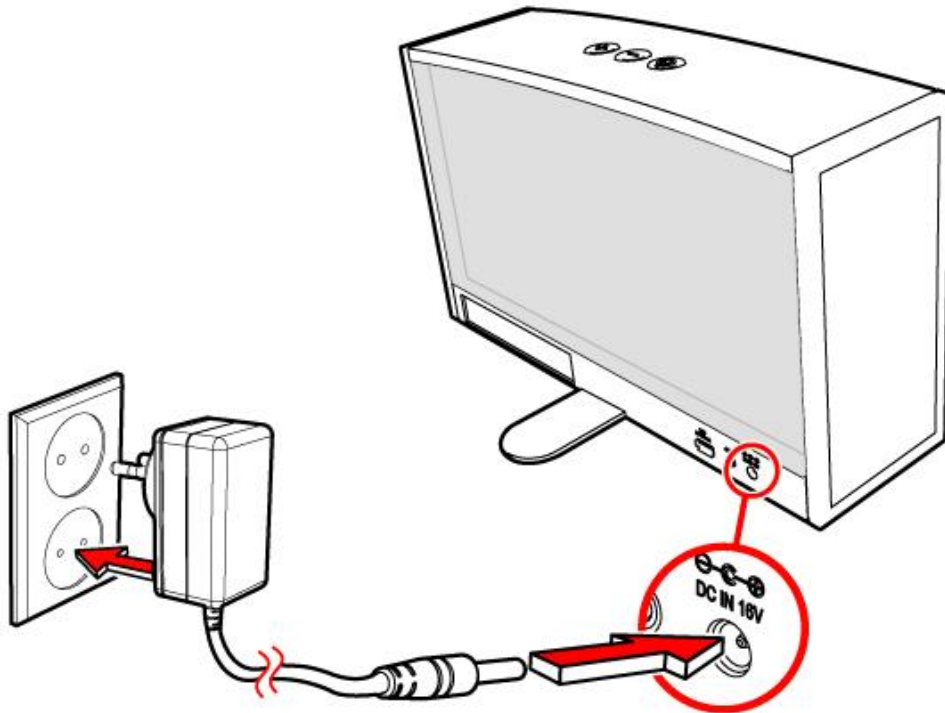

Connect the appliance to the mains.



WARNING Charge the battery for at least 4 hours.

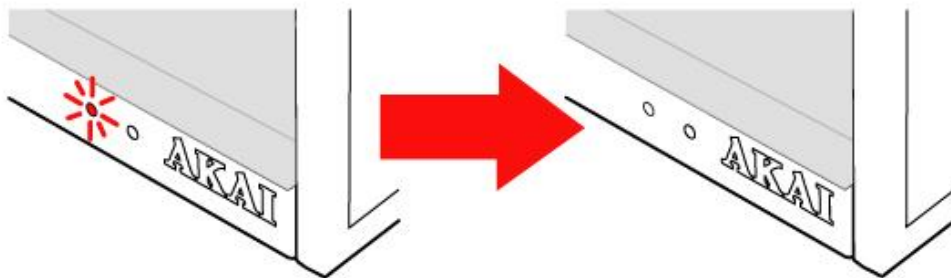

Red LED off: battery fully charged



NOTE:

- The housing of the adapter may become warm during operation. This is normal.
- The red LED may flash when the AWS10 is switched on and is not connected to a power source. This indicates the battery needs to be recharged.
- For longer period of storage, we advice to recharge the battery at least once every two months.

5.Functions

5.1. ASW10BK Bluetooth speaker

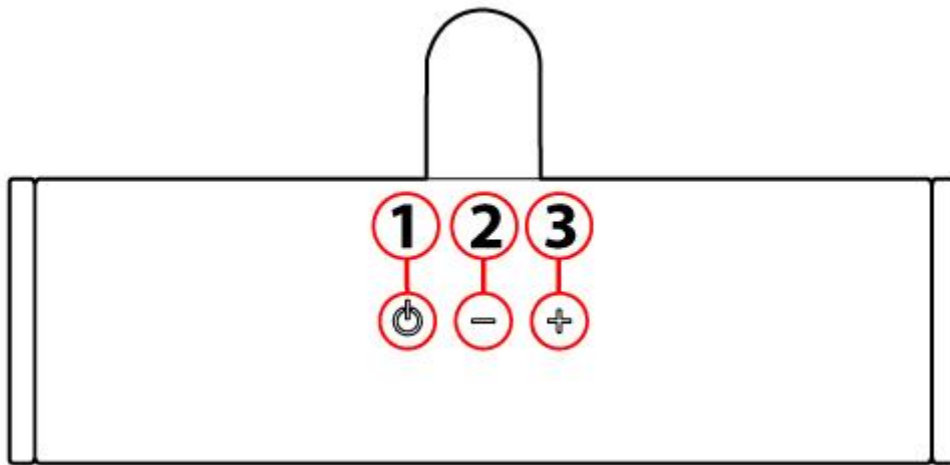

1. POWER button
2. VOL- button
3. VOL+ button

When audio is being played while using the AWS10:

1. PLAY/ PAUSE button

6.Operation

6.1. Turning the device on and off.

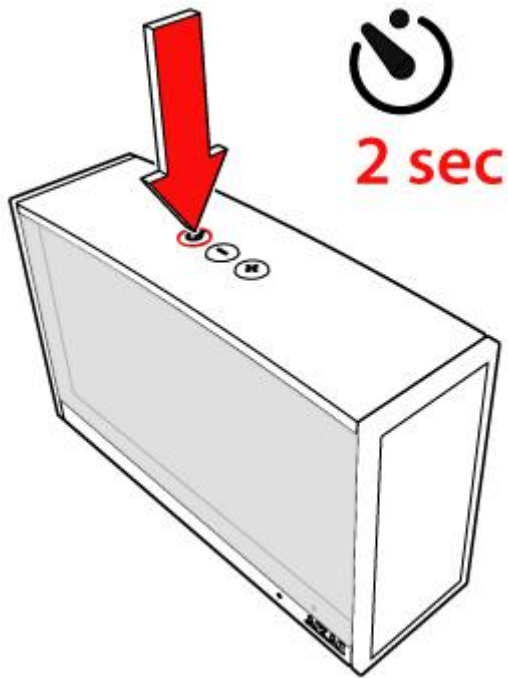

Keep the POWER key pressed down to switch the appliance on / off.



NOTE:

- The AWS10 will enter a power saving mode if no audio is being played for 30 minutes.
- Keep the POWER button pressed down for two seconds to exit the power saving mode.

6.2. Operation with BLUETOOTH

You can wirelessly connect loudspeakers to devices that have Bluetooth A2DP.

Preparation

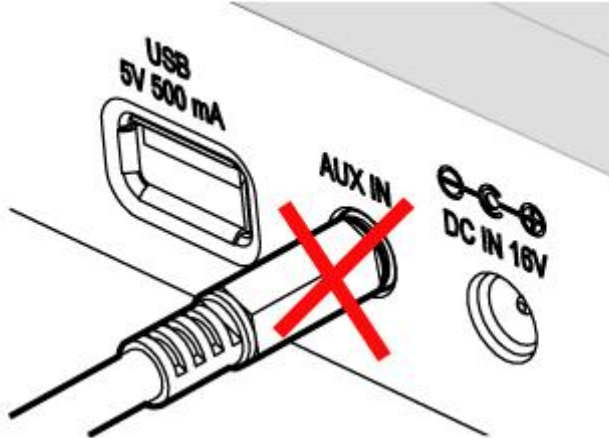

- Make sure the AUX cable is removed from the AWS10. Otherwise the bluetooth connection will not be established.

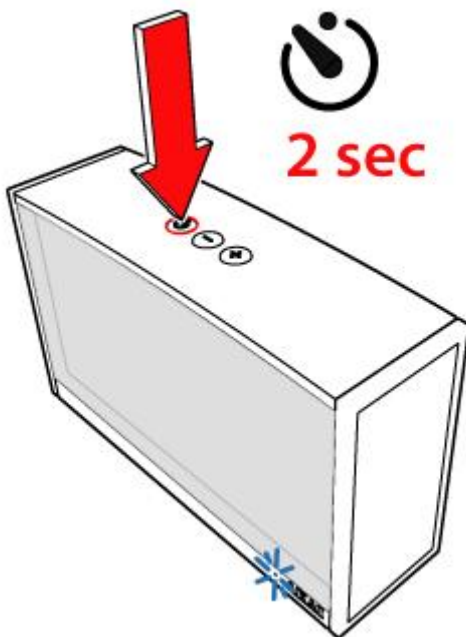

- Keep the key POWER pressed down until the device switches on.
- You will see the blue LED flashing
- Your AWS10 is now ready to establish a wireless connection with your Bluetooth device.
- Turn on the Bluetooth function of your device

Establishing a Bluetooth connection (PAIREN)

- Go to the Bluetooth Menu of your Bluetooth device.
- Search Bluetooth devices and select AWS10 to establish connection

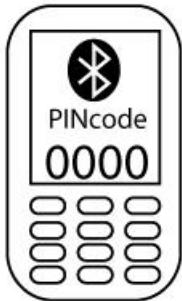

- Enter "0000" when the player asks for the PIN code

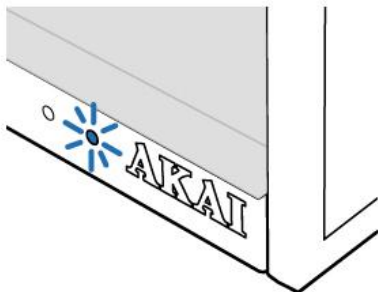

- You will hear a beep.
- The blue LED remains lit as soon as the connection has been established.



NOTE: your Bluetooth connection has a range of approximately 9 metres
The AWS10 is capable of being paired with 8 external devices. However only one paired device can play music using the AWS10.

Reconnect via Bluetooth

If you move outside the Bluetooth range, the connection will be automatically terminated.

- You will see the blue LED flashing
- Establish the connection again by following the steps described above.
If you have previously established a connection with the same device, you no longer need to enter a PIN code.

Disconnect the bluetooth connection

- Press down the VOL- and VOL+ button on the AWS10 at the same time or turn off the paired device.
- You will see the blue LED flashing

6.3. AUX IN

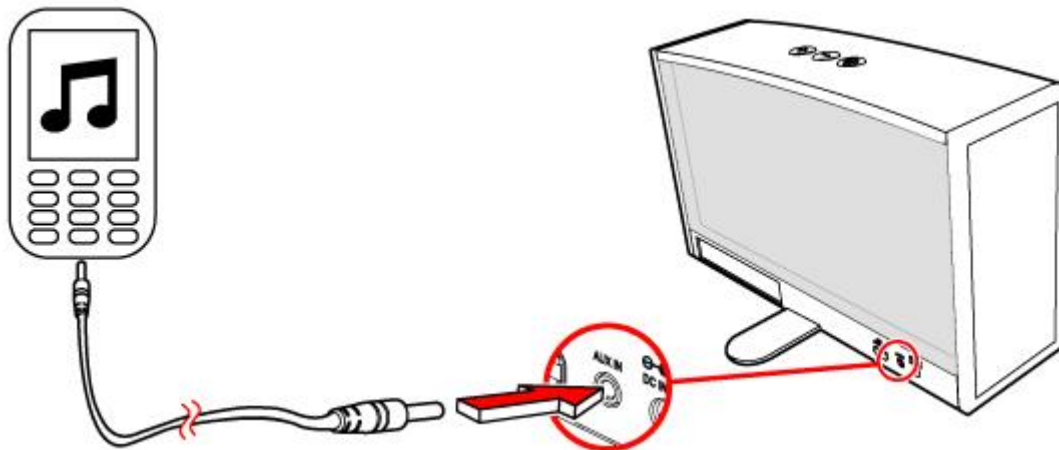

Connect the external appliance to your AWS10.

- Use the supplied AUX cable.
- The AWS10 will automatically switch into AUX mode after inserting the AUX cable.

6.4. USB connection to charge device

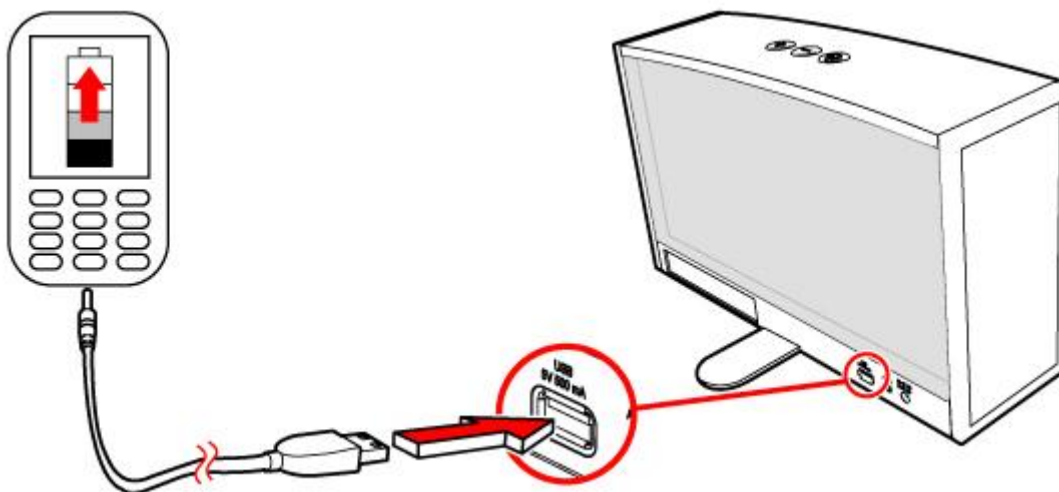

Connect the external appliance to your AWS10.

- Use an USB cable (not included).



NOTE:

- An external device can only be charged when using the USB port.
- The maximum power output of the USB port is 500mA. If your device requires more power, it may not charge.
- The charging function may not be supported by all external devices.

7.Cleaning and maintenance



WARNING Before performing any cleaning or maintenance, switch off and unplug the appliance. Clean the outside of the appliance with a soft cloth. When the appliance is very dirty, dampen the cloth slightly with water and a neutral solution. For longer period of storage, we advice to recharge the battery at least once every two months.

8.Technical data

General functions

Power supply:

Rechargeable build in battery

- Input: AC 100-240V ~ 50/60 Hz
- Output: 16V / 1,8A

Max. power consumption: 35W

Stereo sound: 12,5 x 12,5 Watt

Stereo sound (battery): 10 x 10 Watt

Bluetooth connection

USB 2.0 slot

Dimensions main unit: 220 x 55 x 130 mm

Weight: 1,3 kg

AC/DC Adapter

Speaker system

Impedance: 2 x 8Ω

AUX jack

Input: 3,5 mm

Voltage: 1V

Impedance: 47 KΩ

9. Disposal of used electrical and electronic equipment



The meaning of the symbol on the material, its accessory or packaging indicates that this product shall not be treated as household waste. Please, dispose of this equipment at your applicable collection point for the recycling of electrical and electronic equipments waste. In the European Union and Other European countries which there are separate collection systems for used electrical and electronic product. By ensuring the correct disposal of this product, you will help prevent potentially hazardous to the environment and to human health, which could otherwise be caused by unsuitable waste handling of this product. The recycling of materials will help conserve natural resources. Please do not therefore dispose of your old electrical and electronic equipment with your household waste.

For more detailed information about recycling of this product, please contact your local city office, your household waste disposal service or the shop where you purchased the product.

For more information and warranty conditions, please visit: www.akai.eu



Do not dispose of batteries as household waste but take them to a battery recycling facility.