

## English: ASB12I



### Index

- 1. Safety
- 1.1. Intended use
- 1.2. Labels in this manual
- 1.3. General safety instructions
- 2. Preparations for use
- 3. Installation
- 4. Functions
- 5. Operation
- 6. Cleaning and maintenance
- 7. Technical data
- 8. Disposal of used electrical and electronic equipment

## Safety

### Intended use

The device functions as a docking station for an iPod/ iPhone/ iPad. By downloading the free UniDOCK from the iTunes App Store you can enhance the functionality of your device (NOTE: app is for iPad/ iPhone/ iPod touch only).

Read the manual carefully before the first use.

### Labels in this manual



WARNING A warning means that injury or death is possible if the instructions are not obeyed.



CAUTION A caution means that damage to the equipment is possible.



A note gives additional information, e.g. for a procedure.

## General safety instructions



WARNING Do not put force on the appliance. The appliance can fall and can cause serious injury.



CAUTION Do not spill any liquid on the appliance.



WARNING Do not insert any objects in the ventilation holes.



CAUTION Do not block the ventilation holes.



This appliance is double insulated; therefore no earth wire is required. Always check that the mains voltage corresponds to the voltage on the rating plate.

## Preparations for use

### Unpacking

- Unpack the appliance carefully.
- Check the package contents as described below. If any item is missing, please contact your reseller.



We recommend that you retain the original carton and packing materials in case it ever becomes necessary to return your product for service. This is the only way to safely protect the product against damage in transit. If you do dispose of the carton and the packing materials, please remember to recycle with due care to the environment.

## Package contents

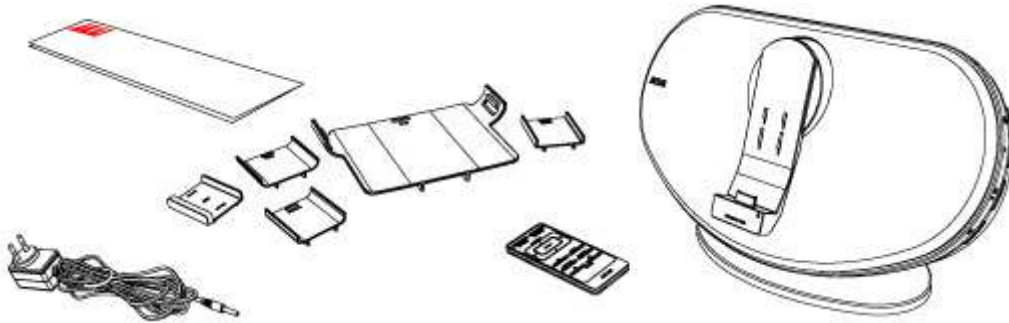

The following items are included in the received package:

- 1 iPod Music System
- 1 Remote control
- 1 x Quick start guide
- 1 Button cell (CR2025)



NOTE: the button cell battery has already been inserted in your remote control



If any item is missing, please contact your reseller.

## Installation

- Put the appliance on a horizontal flat surface.
- Connect the random equipment to the appliance. Read the paragraph "Connecting random equipment".
- Connect the appliance to the mains.
- Activate the battery.

Read the paragraph "Remote control".



CAUTION Do not put the appliance near a heat source.  
Do not expose the appliance to direct sunlight.



This appliance is equipped with rubber feet to prevent it from moving. The feet are made from non-migrating material specially formulated to avoid leaving any marks or stains on furniture. However, certain types of furniture polishes, wood preservatives or cleaning sprays cause the rubber to soften and leave marks or a residue on the furniture, and potentially risk the surface to become damaged. To prevent damage to wooden surfaces, we recommend that you apply self-adhesive pads to the bottom of the rubber feet before installation.

## Activating the battery

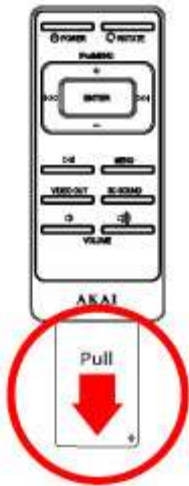

- Carefully pull the foil out of the battery holder without opening the holder. The battery has now been activated.

## change the battery

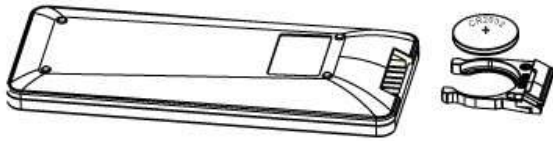

Pull out the battery holder  
Insert 1 lithium battery, type CR2025 3V battery  
When inserting the battery observe the (+) and (-) polarity markings.  
Insert the battery tray into the remote control.

## Connecting to the mains

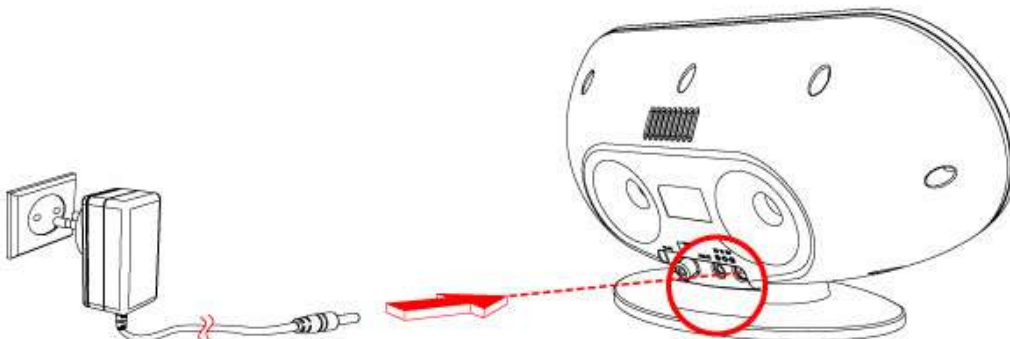

- Connect the female connector on the mains cable to the AC MAINS connection.
- Connect the mains plug to a wall socket.

**Connecting external devices**  
**AUX jack**

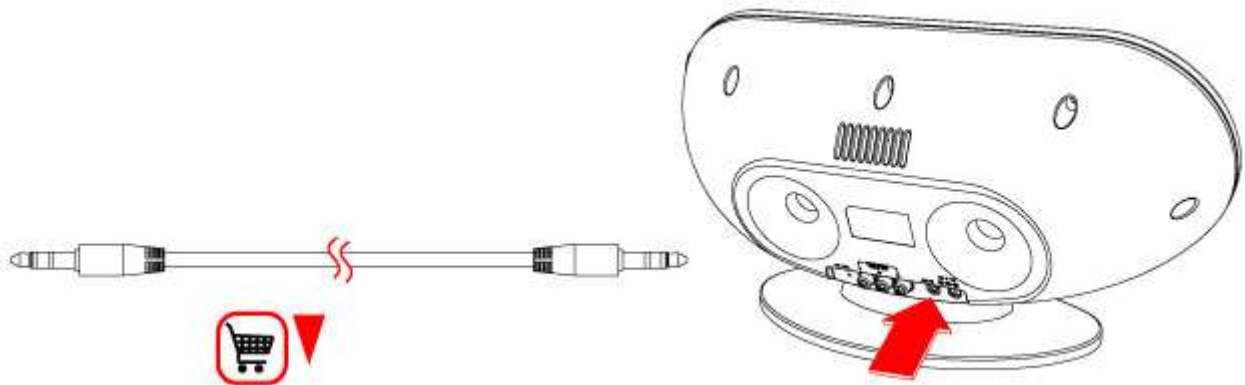

**Video connection**



**Choosing and placing the iPad/ iPhone/ iPod adaptors**

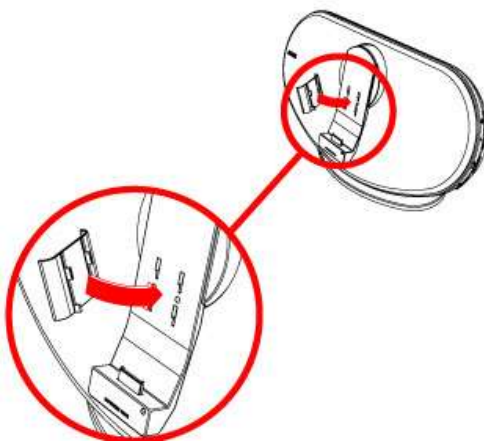

|                         |                                                                                            |
|-------------------------|--------------------------------------------------------------------------------------------|
| Adaptor A: iPhone       | iPhone, iPhone 3G, iPhone 3GS, iPod classic(1st/2nd generation), iPod nano(6th Generation) |
| Adaptor B: iPhone 4     | iPhone 4                                                                                   |
| Adaptor C: iPod         | Touch, iPod Touch(1st / 2nd / 3rd / 4th generation), iPod nano(1st / 2nd / 3rd generation) |
| Adaptor D: 4G / 5G nano | iPod nano(4th / 5th generation)                                                            |
| iPad                    | iPad                                                                                       |
| iPad2                   | iPad2                                                                                      |

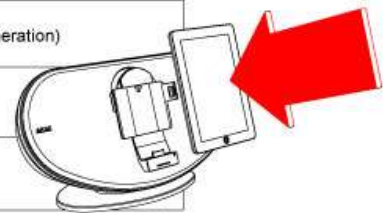

- Select the right adaptor. Consult the above table for this.

- Slide the dock adaptor in the holder. Place your iPad/ iPhone/ iPod



Please note:  
 Use the right dock adaptor. Placing it incorrectly may damage your iPod/iPhone.

## Rotate your Apple device for landscape view

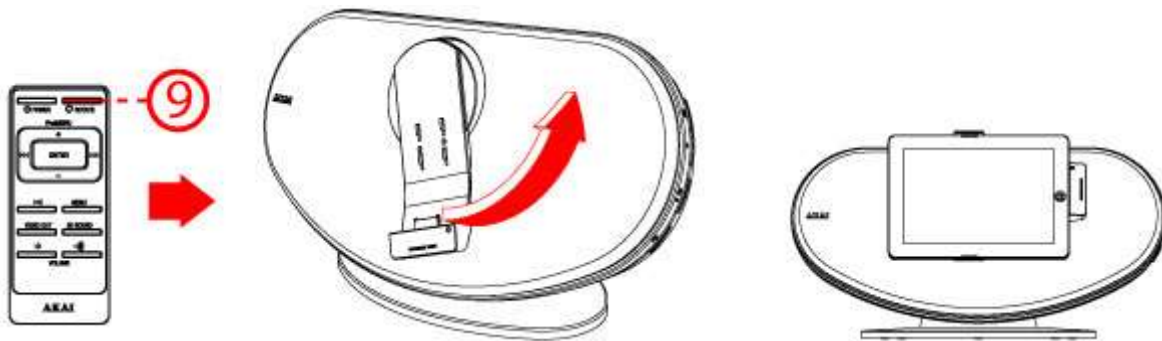

- Rotate for landscape view
- Use the ROTATE (9) key for this. This key is located on your remote control.

## Functions

### Remote control

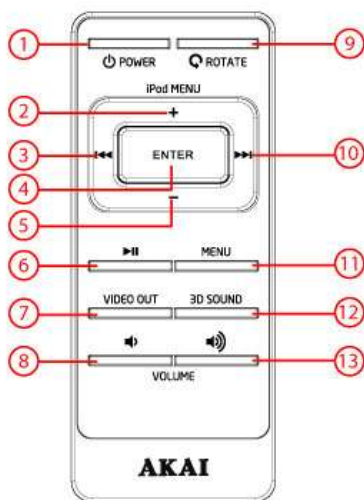

1. POWER button
2. iPod MENU + button
3. SKIP PREV button
4. ENTER button
5. iPod MENU - button
6. PLAY/ PAUSE button
7. VIDEO OUT button
8. VOLUME - button
9. ROTATE button
10. SKIP NEXT button
11. MENU button
12. 3D SOUND button
13. VOLUME + button

## ASB12I docking-station

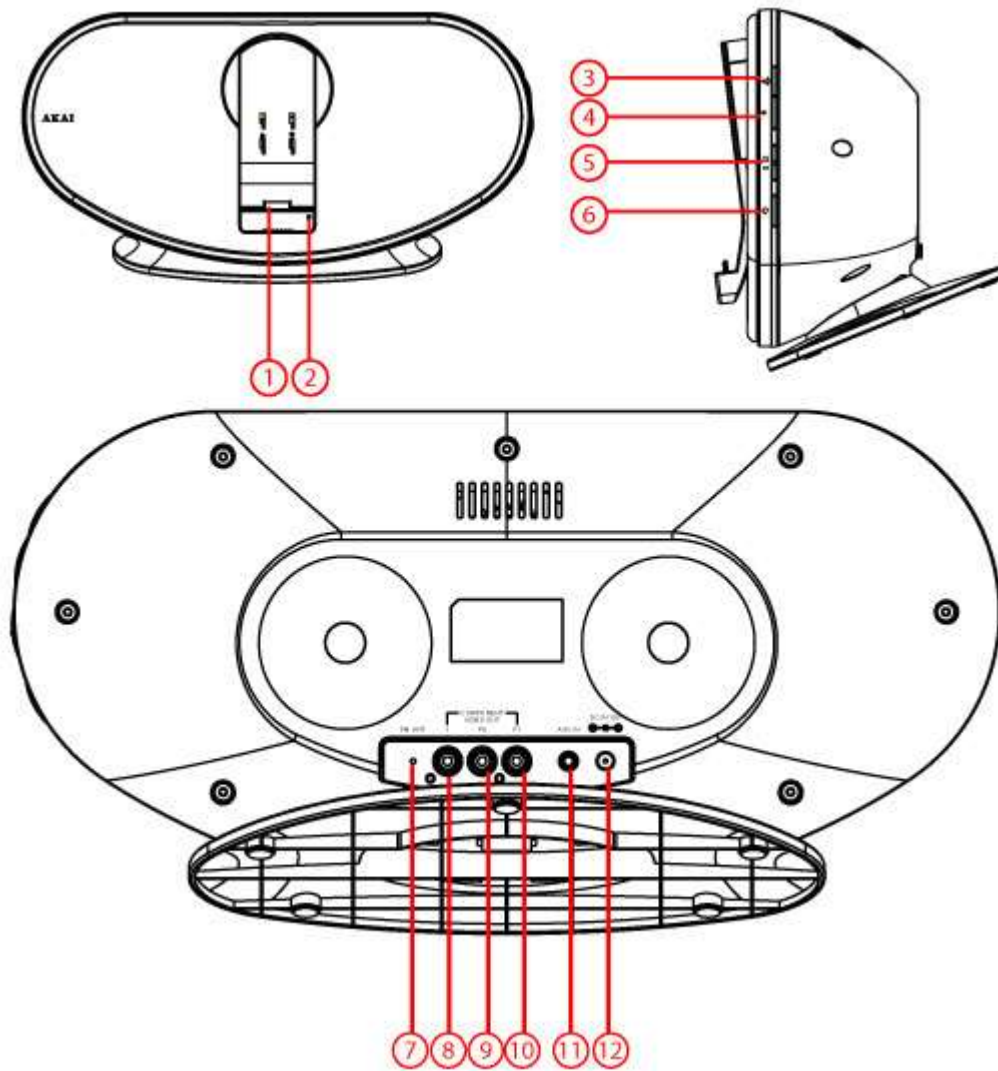

1. iPad/ iPhone/ iPod dock
2. REPEAT iPOWER
3. VOLUME + button
4. VOLUME - button
5. POWER ON/OFF/PLAY/PAUSE button
6. ROTATE button
7. FM antenna
8. COMPONENT VIDEO OUT Y Jack
9. COMPONENT VIDEO OUT Pb Jack
10. COMPONENT VIDEO OUT Pr Jack
11. AUX IN Jack
12. DC IN Jack

## Operation

All functions of the appliance are accessible using the remote control. All instructions refer to operation with the remote control, unless indicated otherwise.

### Turning the device on and off.

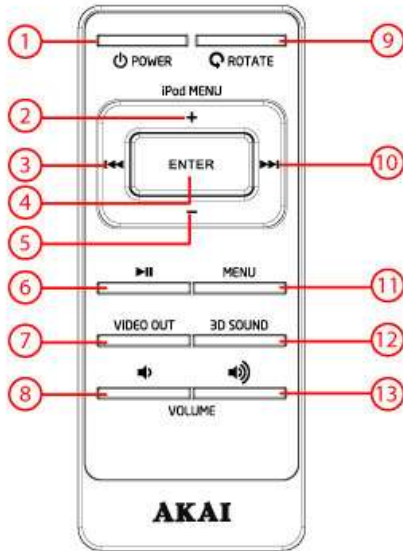

- Switch on (off) the ASB121
- Use the POWER (1) key for this.

This key is located on your remote control.

### The CLOCK RADIO app

By downloading the free UniDOCK from the iTunes App Store you can enhance the functionality of your device (NOTE: app is for iPad/ iPhone/ iPod touch only).

The first time you place your iPad/ iPhone/ iPod in the ASB211 docking station you will be prompted to download the UniDOCK from the App Store.

After you have downloaded your UniDOCK and completed the installation, you can start using the UniDOCK. To do this, select the app on your iPad/ iPhone/ iPod.

After you have downloaded your UniDOCK and completed the installation, you can start using the UniDOCK. To do this, select the app on your iPad/ iPhone/ iPod.



## Summary UniDOCK functions



- 1 Playback controls
- 2 Alarm
- 3 SLEEP
- 4 iPod
- 5 FM TUNER
- 6 EQ
- 7 Settings

## Alarm



- 8 Back (to previous screen)
- 9 Edit alarm
- 10 Add alarm

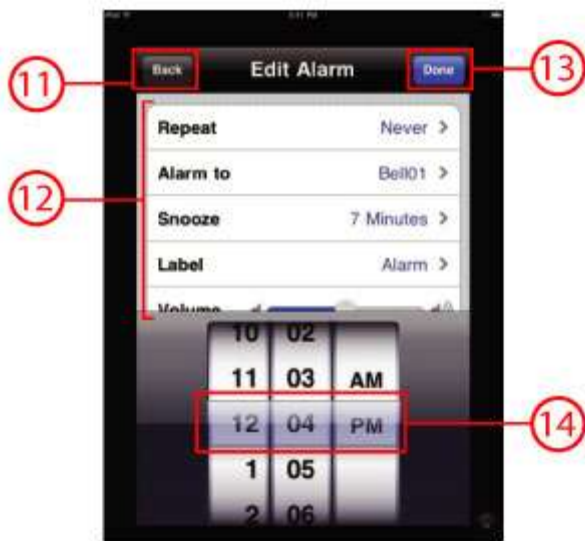

- 11 Back (to previous screen)
- 12 Alarm settings
- 13 Save settings and return to previous screen
- 14 Edit alarm time

## Settings

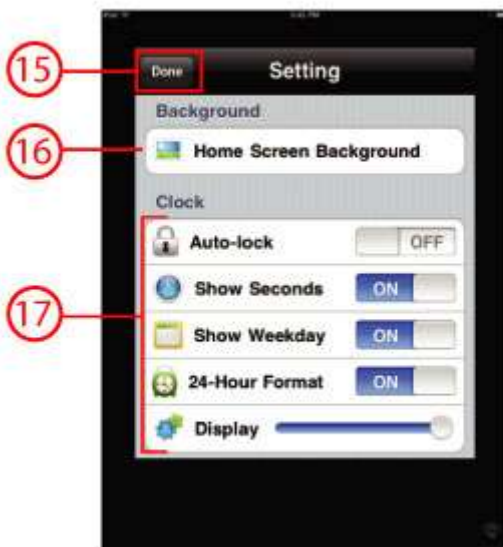

- 15 Save settings and return to previous screen
- 16 Change the background setting
- 17 Change the clock settings

## FM tuner

### FM antenna

Uncoil the FM antenna as far as possible

### Operating the radio

1. While UniDOCK is activated, press FM TUNER or repeatedly press MENU on the remote control to open the radio menu.
2. Search for the desired frequency with the PREV button or the NEXT button .  
These keys can be found on your remote control

1. The radio stops searching when it detects the next station



- Touch (18) to add the current station to your favourites  
Use the volume slider (19) to adjust the volume.  
Touch (20) to open your favourites  
Touch (21) to set your region and to switch stereo on/ off.

## iPad/ iPhone/ iPod functions

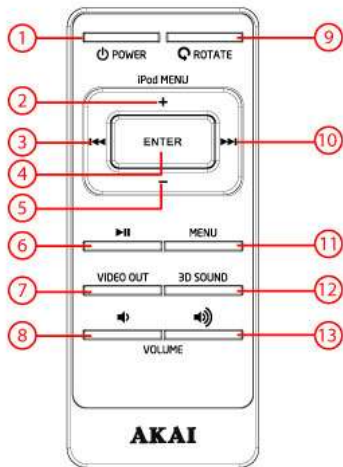

### Audio playback

During playback, the following functions are available:

To start playback, press the PLAY/PAUSE button (6) once.

To pause playback, press the PLAY/PAUSE button (6) once; to resume playback, press the button again.

To adjust the volume, press the VOL + (13) button or the VOL - button (13).

To select a track, press the PREV button (3) or the NEXT button (10) until the desired track is set.

To forward or rewind the track, press and hold the PREV button (3) or the NEXT button (10).

With the 3D SOUND (12) key you can turn on/off the surround sound.

Press the MENU (11) key to open the menu of your iPad/ iPhone/ iPod. This key works the same as the MENU key of your iPad/ iPhone/ iPod.

Use the + and - keys to navigate within the menu.

Press the ENTER button (4) to enter the selected menu item.

Use the ROTATION (9) key to switch the image between vertical (portrait) and horizontal (landscape)



NOTE: navigating through the menu is not possible for TOUCH SCREEN products, such as the iPad and the iPod nano sixth generation.

## Operation with BLUETOOTH

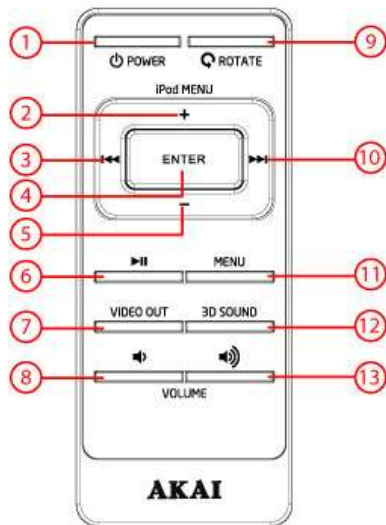

You can wirelessly connect loudspeakers to devices that have Bluetooth A2DP.

### Preparation

Keep the key POWER pressed down until the device switches on with a beep.

You will see the blue LED flashing

Your ASB211 is now ready to establish a wireless connection with the your Bluetooth device.

Turn on the Bluetooth function of your device

### Establishing a Bluetooth connection (PAIREN)

Go to the Bluetooth Menu of your Bluetooth device.

Search Bluetooth devices and select "AKAI ASB12" to establish connection

Enter "0000" when the player asks for the PIN code

The blue LED will flash slowly as soon as the connection has been established



NOTE: your Bluetooth connection has a range of approximately 9 metres

### Reconnect via Bluetooth

If you move outside the Bluetooth range, the connection will be automatically terminated.

Establish the connection again by following the steps described above.

If you have previously established a connection with the same device, you no longer need to enter a PIN code.

### Connect to another Bluetooth device

End the existing Bluetooth connection with the connected device.

For this, go to the Bluetooth menu of your Bluetooth device

Follow the steps described above to establish a new connection.

## Video operation

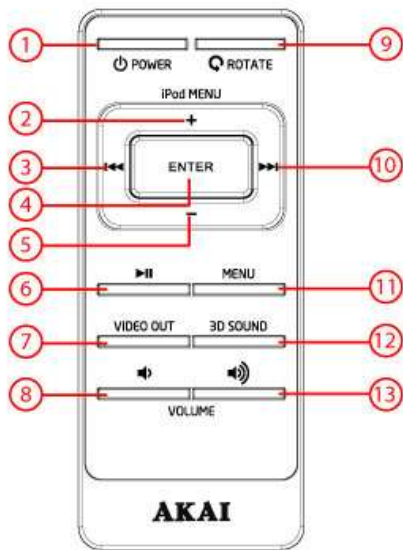

It is possible to watch images of your iPad/ iPhone/ iPod via your ASB12I on your TV  
Connect your ASB12I to your TV  
See for instructions section 3.4

### Play video on your TV

Select the video icon in the iPad/ iPhone/ iPod menu  
Select a video file and start playback  
Press the VIDEO OUT button .  
This key is located on your remote control.



NOTE: this functionality is suitable for the following APPLE devices:

iPod nano (3rd, 4th & 5th generation), iPod touch (2nd generation), iPod classic at 480p or 576p resolution; iPod touch (1st generation), iPhone, iPhone 3G, iPhone 3GS, iPhone 4, iPad at 480p / 576p resolution

## Cleaning and maintenance



**WARNING** Before performing any cleaning or maintenance, switch off and unplug the appliance.  
Clean the outside of the appliance with a soft cloth. When the appliance is very dirty, dampen the cloth slightly with water and a neutral solution.

## Technical data

Voltage: 220VAC / 50 Hz  
Power consumption: 30W  
Standby power consumption: < 1W  
Max power: 2 x 10W RMS  
Frequency response: L/R CH (60Hz-20KHz at +1 / -2dB)  
Dimensions: 400 x 164 x 199 mm  
Weight: 2,2 KG

### Remote control

Power consumption: 2 x 1,5V  
Battery size: Cr2032

### Working environment

Operating temperature: - 10 ~ +40 C(elsius)  
Relative humidity: 5% ~90%

### Suitable for the following Apple devices

## Disposal of used electrical and electronic equipment



The meaning of the symbol on the material, its accessory or packaging indicates that this product shall not be treated as household waste. Please, dispose of this equipment at your applicable collection point for the recycling of electrical and electronic equipments waste. In the European Union and Other European countries which there are separate collection systems for used electrical and electronic product. By ensuring the correct disposal of this product, you will help prevent potentially hazardous to the environment and to human health, which could otherwise be caused by unsuitable waste handling of this product. The recycling of materials will help conserve natural resources. Please do not therefore dispose of your old electrical and electronic equipment with your household waste.

For more detailed information about recycling of this product, please contact your local city office, your household waste disposal service or the shop where you purchased the product.

For more information and warranty conditions, please visit: [www.akai.eu](http://www.akai.eu)



Do not dispose of batteries as household waste but take them to a battery recycling facility.